

Outdoor Temperature Sensor IP65

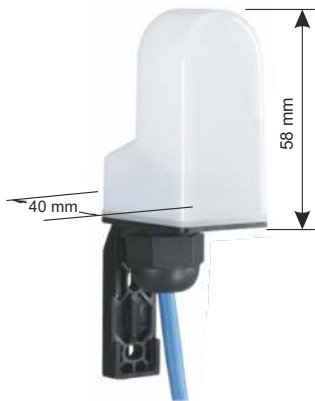

Outside IP65
Range °C: -50...90

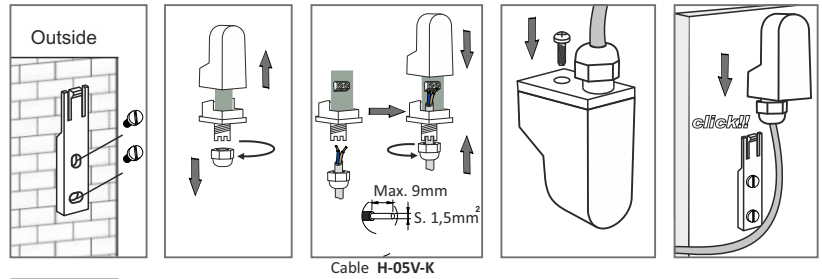

Model	Value: 0°C	Value: 25°C
SONEXT 101 KTY81-210	-	2.000 ohms
SONEXT 101 NTC1.8K	-	1.800 ohms
SONEXT 101 NTC10K	-	10.000 ohms
SONEXT 101 NTC20K	-	20.000 ohms
SONEXT 101 Ni1000	1.000 ohms	-
SONEXT 101 Pt100	100 ohms	-
SONEXT 101 Pt500	500 ohms	-
SONEXT 101 Pt1000	1.000 ohms	-
SONEXT 101 LM235Z3	2.73 V	-
SONEXT 101* PTC2000	-	1.990 ohms



Without adjustment IP30
Range °C: -50...+90°C



and forget about unnecessary accessories!

Ambient probe without adjustment IP30

Model	Value: 0°C	Value: 25°C
SONAMB 201 KTY81-210	-	2.000 ohms
SONAMB 201 NTC1.8K	-	1.800 ohms
SONAMB 201 NTC10K	-	10.000 ohms
SONAMB 201 NTC20K	-	20.000 ohms
SONAMB 201 Ni1000	1.000 ohms	-
SONAMB 201 Pt100	100 ohms	-
SONAMB 201 Pt500	500 ohms	-
SONAMB 201 Pt1000	1.000 ohms	-
SONAMB 201 LM235Z	2.73 V	-
SONAMB 201 PTC2000*	-	1.990 ohms

Transducers 4a20mA TEMPERATURE and HUMIDITY

- Protection: IP30
- Power supply: 9 to 24 Vdc
- Maximum consumption: 20mA
- Output load: 50W
- Response time: 30 seconds

TEMPERATURE PROBE

- Accuracy Z ±5%.
- Range: 0°C to +100°C
- Response: at 0°C gives 4mA
at 100°C gives 20mA

HUMIDITY PROBE

- Accuracy Z ±3%
- Range: 20% to 98% R.H.
- Response: at 20% R.H. gives 5.6mA
at 98% R.H. gives 19.7mA

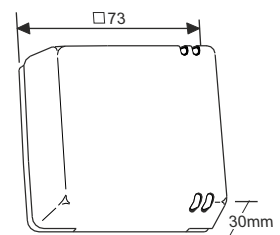

Hall Probe



Model	Code	Characteristics
Sonda Pasillo 4a20mA T ^a	5.684	IP 20. Range: 0°C to +70°C
Sonda Pasillo 4a20mA HR	5.685	IP 20. Range: 20% from 98 % R.H.
Sonda Pasillo 4a20mA Dual	5.686	Rangos: 20-98% R.H. / 0°C to +70°C