



Instructions Manual



Siesta 105 WiFi

Chronothermostat WiFi

Code: 29.101

Smart chronothermostat with WiFi communication

Heating / Cooling includes App Sonder Home

Warnings

Safety instructions

- Before installing the control, make sure that the environmental conditions are the necessary, working temperature, humidity, pollution and emission of gases, since any of these factors can affect its correct operation.
- For any manipulation, either while installing or repairing, the control must be disconnected from the mains.
- It is an independent control device for surface mounting on a 60 mm diameter junction box.
- The electrical connections can only be those indicated in this manual and on the device connection label.
- This control is not a safety device, nor can it be used as such, it is the responsibility of the installer to incorporate the appropriate protection to each type of installation (approved).
- Assembly, electrical connection, commissioning and maintenance should only be carried out by qualified personnel.
- In case of visualizing possible defects in the device that could cause damage or a malfunction in the installation, do not connect the device.
- In case of doubts about its operation or its correct installation, do not connect the device to the mains and consult a professional technician.
- Sonder Regulación S.A. reserves the right to make changes related to the product, technical data, or assembly and use instructions without prior notice.

Designed and manufactured according to:

UNE-EN 60730-1 + A1: 2005 + A12: 2004 + A13: 2005

UNE-EN 60730-2-1: 1998 + A11: 2005



Directive 2012/19 / EU on waste electrical and electronic equipment (WEEE) The product and its packaging must be disposed of at the corresponding recycling center



Warranty conditions

This device has a 3-year warranty, it is limited to the replacement of the defective part and will be delivered in the same material reception conditions, packaging, batteries, instructions or any other accessory that includes this product will not be replaced.

We decline all responsibility for damaged devices, as a result of mishandling, omission of the warnings in this manual or technical ignorance of the installation's needs.

For any repair under warranty it is necessary to present the documentation proving the purchase of the product within the term of validity of this warranty and a description as exact as possible of the defect or the anomalous behavior of the product according to the user.

If the repair is out of warranty, the user will be informed of the feasibility and cost of it. The valuation of our technical department may involve an additional cost for the user.

They are out of warranty:

Devices whose serial number has been damaged, deleted or modified.

Devices whose connection or use have not been executed according to the instructions attached to the device.

Modified devices without prior agreement with the manufacturer.

Devices whose deterioration is the result of crashes or liquid or gaseous emanations.

Appliances with natural wear or improper use of the equipment.

The costs resulting from the shipment or receipt of the material.

Compensation requirements due to loss of earnings, compensation for use as well as indirect damages, provided they are not mandatory under the law

INDEX

Warnings	2
Presentation	4
Content	4
Characteristics	4
Functioning	4
Installation	5
Location	5
Connection and Examples	6
App Installation	7
Error Screens	11
Thermostat	
Display	12
Keyboard	12
Leds	14
WiFi Reset Button	14
App	
App	15
Home	16
Registros	16
Programación	17
Configuración	18

Presentation

First of all we thank you for the purchase and trust placed in the equipment and we hope that it meets the needs of your installation.

The Siesta 105 WiFi is a smart thermostat for heating or cooling and App with WiFi communication. Through the Sonder Home App, access the advanced settings.

You can program the operation, configure the parameters, you can even lock the thermostat keyboard so that it can

only be adjusted from the App. Steps to follow:

- Install junction box and thermostat without connecting the power.
- Download App and install on mobile phone (page 7)
- Power the box and press ready in the App to synchronize
- Finish installing the App

Content

Thermostat

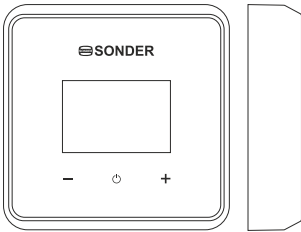

Link Box

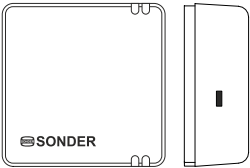

Optional accessory Code: 3.970
Placa TA (installation plate + screws)

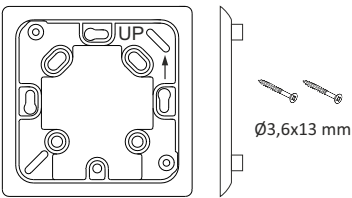

Characteristics

Techniques

Power Supply Link box:..... **230V~ 50/60Hz**
Setpoint temperature range:..... **from 5°C to 35°C**
Reading room temperature:..... **0°C to 40°C**
Storage temperature:..... **maximum 50°C**
Breaking power (contacts):..... **5(1)A 250Vac**
Maximum section of the cable to connect:..... **1,5mm²**
Wiring Type:..... **H-05V-K**
Degree of protection:..... **IP20**
Pollution Degree:..... **2**
Software:..... **Clase A**
Type of Action according to EN 60730:..... **1.B**
Approved:..... **CE**

Physical

Thermostat:..... **105 x 105 x 25 mm**
Link box:..... **76 x 76 x 30 mm**
Placa TA Ø60 (optional code 3.970):... **85 x 85 x 5 mm**
Weight net:..... **119 g**
Weight gross:..... **139 g**
Display e-ink:..... **2,7"**

Communication

Compatible with: **Wi-Fi 802.11 b/g/r (2,4GHz)**
Support Wi-Fi security: **Open/WEP/WFA/
WPA2-personal (TKIP y AES)**
Distance between thermostat and receiver: **75 m**

Functioning

Boiler



Link Box



Thermostat



Installation

Before any manipulation, make sure that the electric current is disconnected.

The connection cables between the Link box and the thermostat must not exceed 75 m, type H-05V-K, 2-wire flexible and NEVER go through the same channel as the electrical cables.

Installation plate (optional)

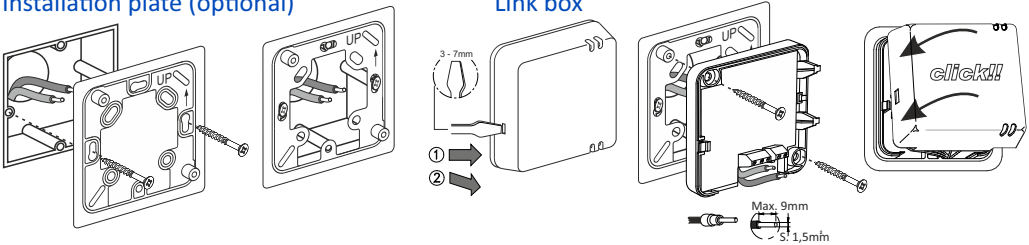

Location

Keep at least 30 cm away from other electronic devices.

Thermostat

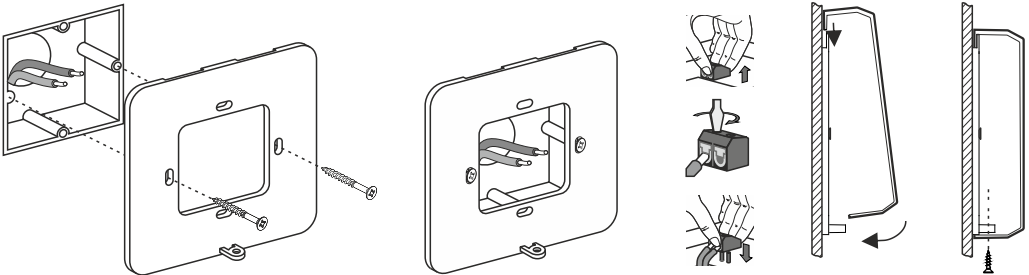

Location

Must be installed away from sources of heat, direct sunlight or drafts. Height 1.5m approximately to facilitate visibility . before fixing it to the wall check the coverage between the thermostat and the wifi

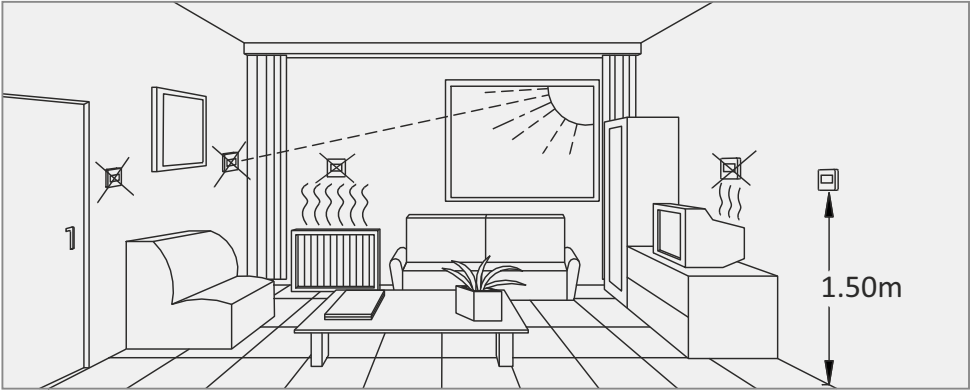

Connection and Examples

When there is a power failure, the receiver may take 1 minute to recover the synchronization with the thermostat, but it saves all data and settings.

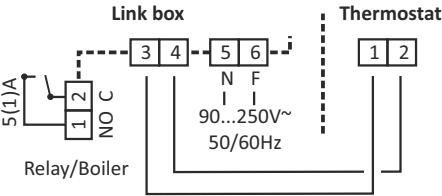
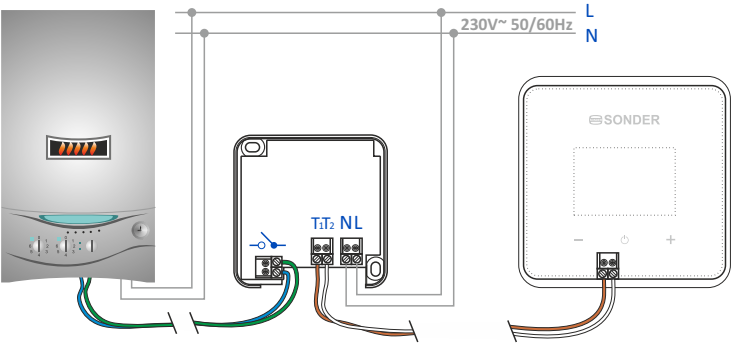

Boiler powered at 230V ~ All/Nothing action

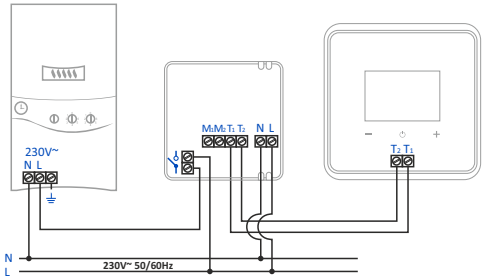

Boiler combined action All/Nothing

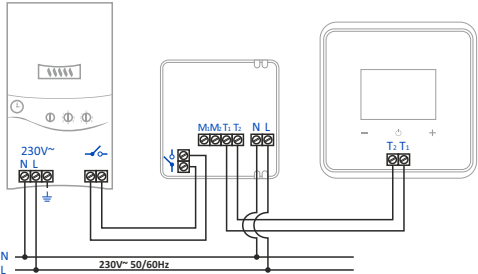

2-way zone valve powered at 230V ~ All/Nothing action

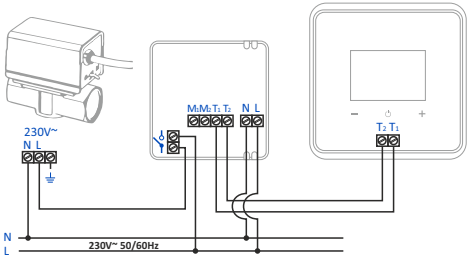

App Installtion

- Download App "Sonder Home" from the respective store to your operating system & install.
- Open the application by clicking on the "Sonder Home" app icon



QR direct to download



Create the account the device will be associated with in Create New Account (Log In if you have an account)

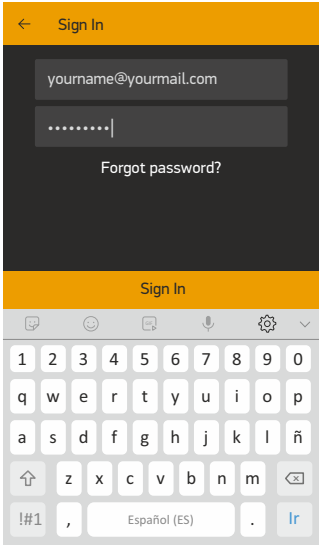

It asks for mail and password to create a user.

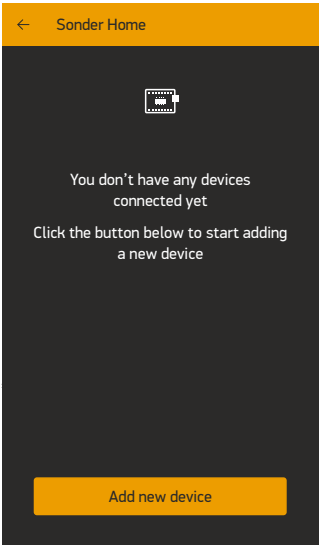

Add device to control

WiFi configuration on the device to control

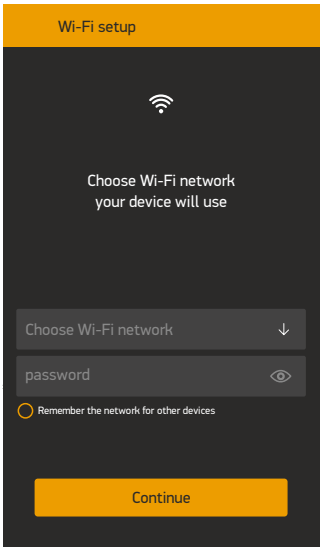

WiFi data where the device to be controlled will be connected

WiFi network (Invalid 5G)

WiFi Password

It asks you to connect the receiver to the power, when the blue light of the receiver (🔵) turns on and off slowly, press Ready

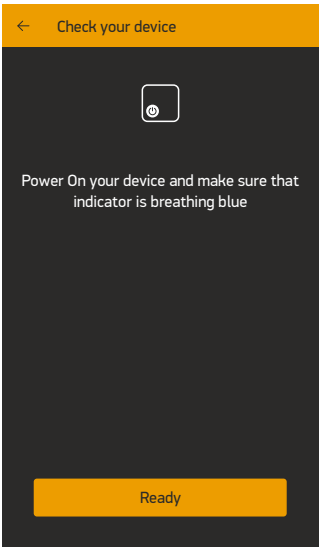



Add device

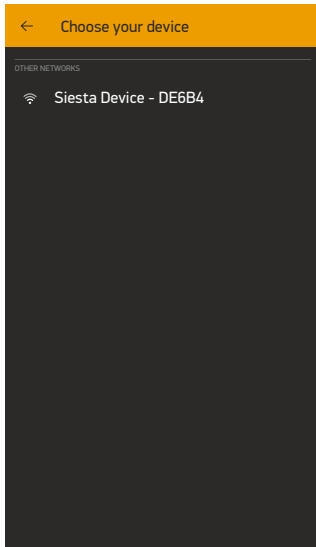

Sending home WiFi data to the device to be controlled

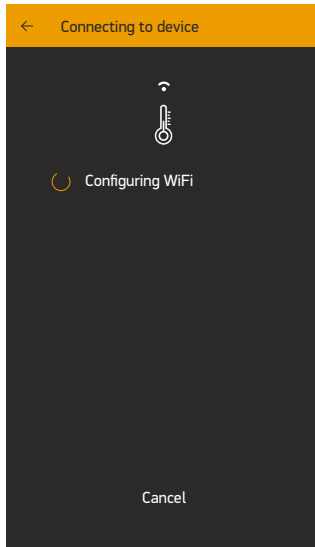

WiFi synchronization with the device to be controlled

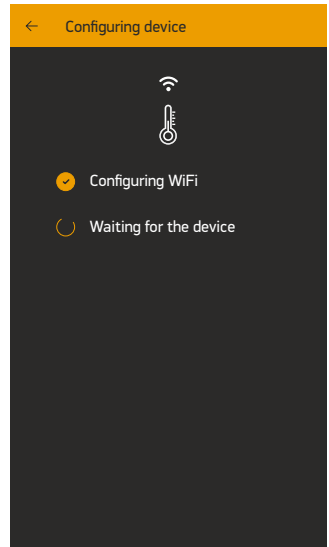

Comprobación final

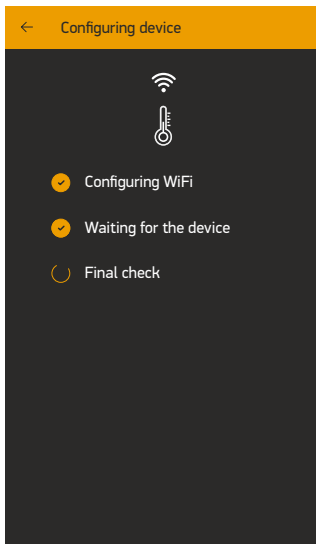

Customize product



By clicking on the name you can change it

By clicking on the thermometer you can choose another icon

Clicking on +Add another device adds another device to your App

Pressing Continue takes you to the main App screen



Setting up the Wi-Fi that generates the Siesta on your iPhone

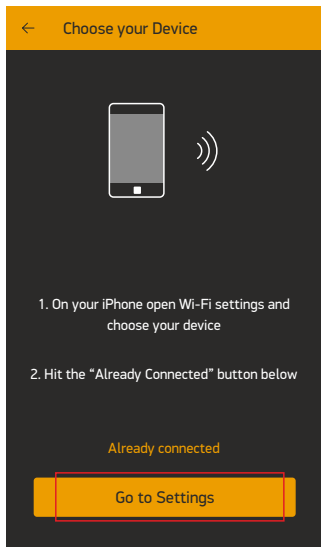

press Go to Settings

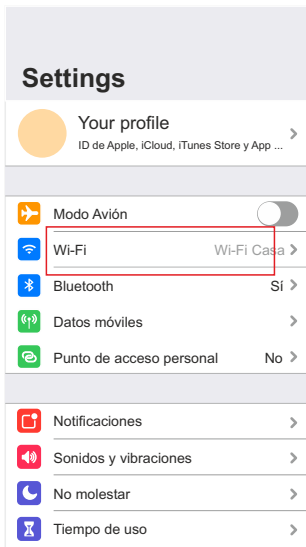

Go to your iPhone settings and enter in Wi-Fi

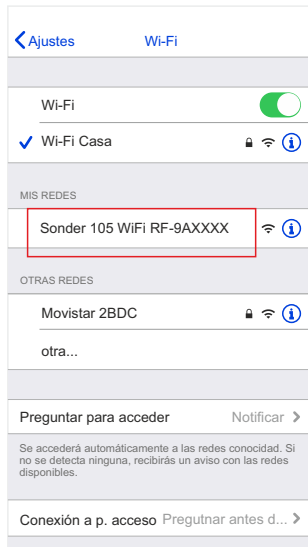

Select the Wi-Fi network that generates the Siesta 105

come back to App
and press Already connected

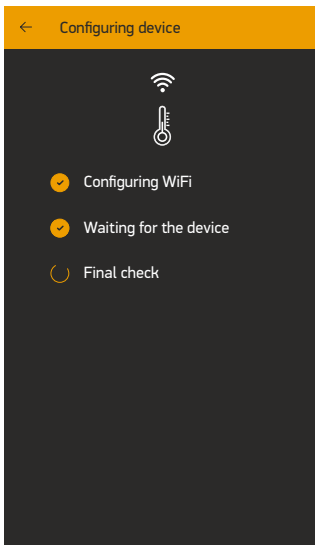
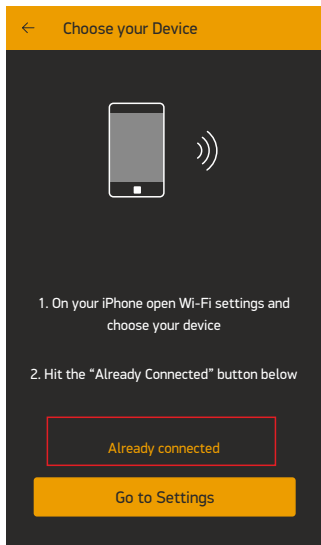

Customize product
You can change the name and icon



Main App screen

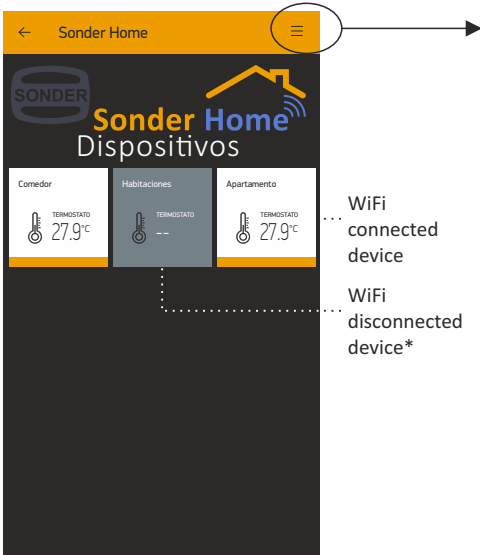

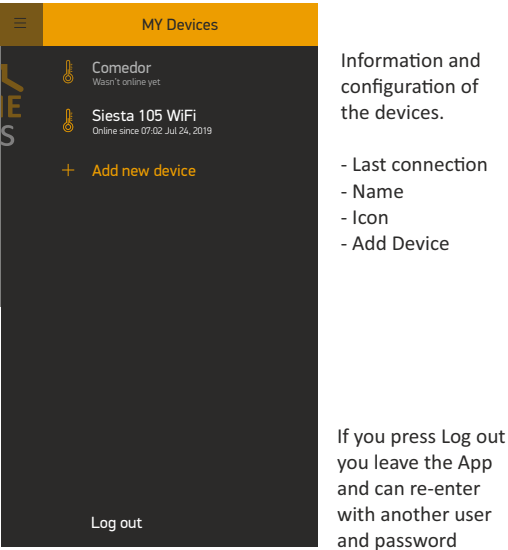

* Check the status of the Wifi and if correct, turn off the power to the receiver, wait 10 seconds and turn on again

Device access menu*

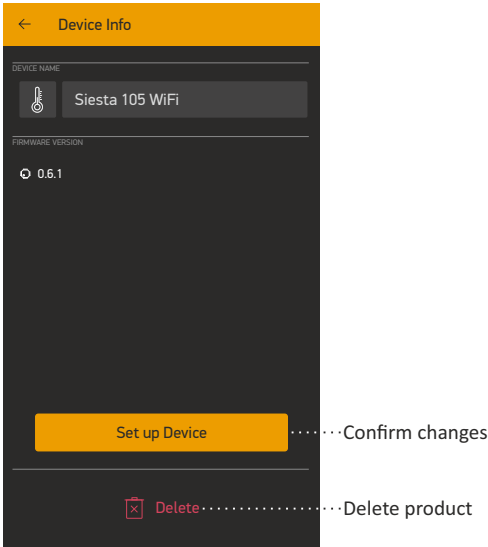

Click on the device to access the configuration menu.



* If you click on  you also enter the device access menu



Connection error screen

Appears when the Wi-Fi settings on the device fail

- Check Wi-Fi status and settings.
- Check that you have typed in the name of the Wi-Fi network you have at home and to which Siesta will connect.
- Check that the Wi-Fi network you are trying to connect to is 2.4 GHz. (5GHZ does not work)
- Check that you have typed the password correctly.
- To check it you can connect from your phone to that Wi-Fi and if you do not connect is that there is some error of writing. If you have already memorized that network in your phone, you must delete it and reconfigure it to check that you write the text correctly.



Screen for Android

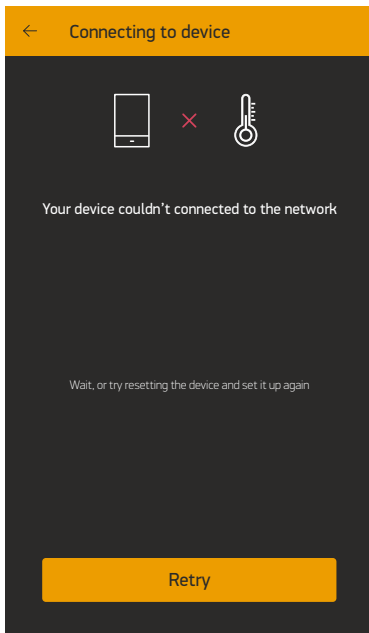

Screen for IOS

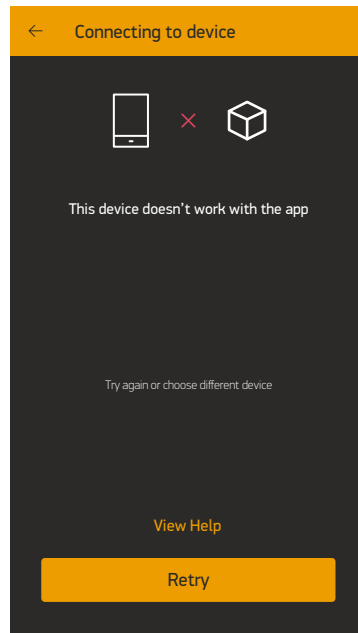

Thermostat display

The thermostat has a basic operation, the setpoint temperature rises or falls (desired room temperature). If it is in programmed (automatic) regulation mode, it will return to its programming in the following period. You can also turn off (anti-freeze setpoint).

From the App you can set parameters, regulation mode (heating or cooling), schedule a schedule and check records. The regulation of the room can be manually or automatically (it has time programming for independent heating and cooling).

From the App you can lock the keyboard of the thermostat so that it cannot be manipulated. Public spaces, schools, shelters, public places.

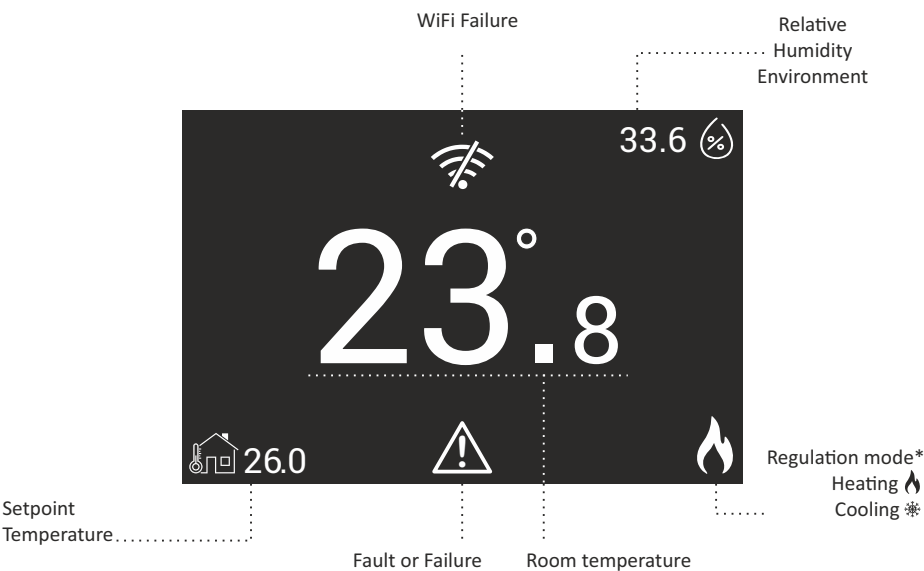

* Only the icon is displayed when it is running

Keyboard

To change the setpoint, press and hold + or - until you see the image increase

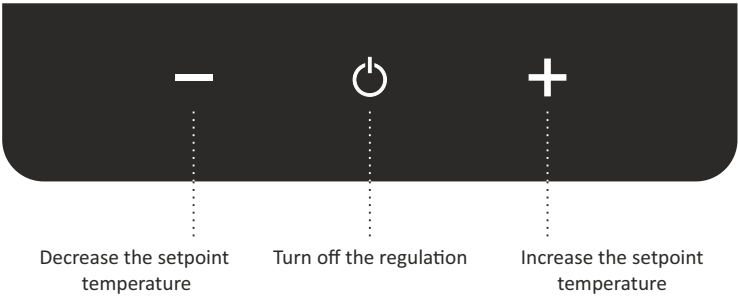

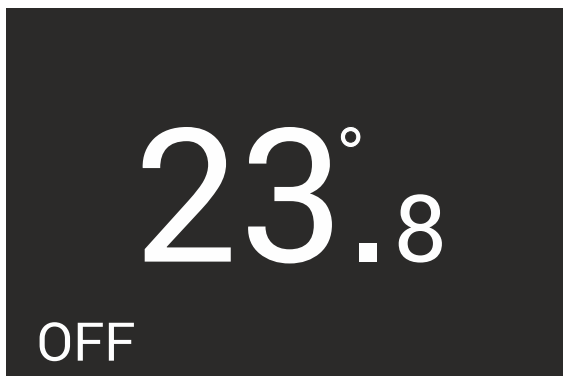

Off

If we press the button  for 2 seconds, the thermostat is turned off, it disables the regulation and keeps the antifreeze.

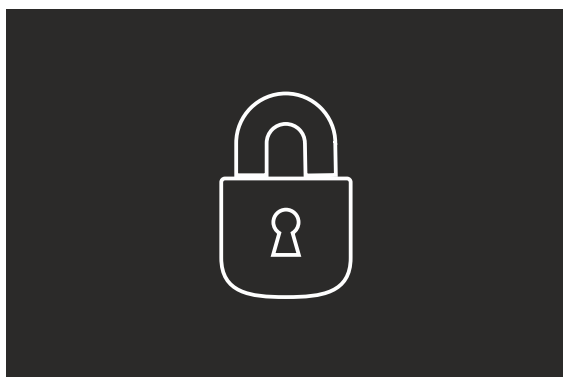

Locked

Screen that appears 3 seconds when we try to raise or lower the setpoint from the thermostat and we have locked the keyboard from the App.

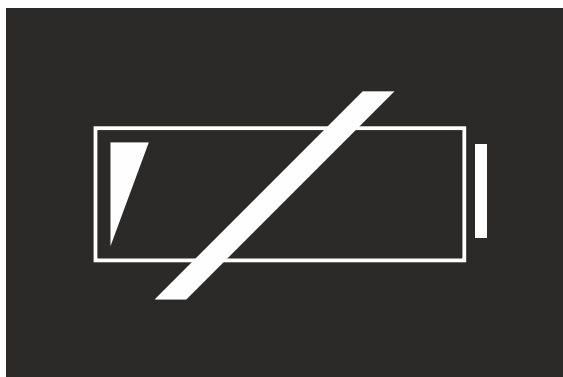

Exhausted batteries

Screen that appears when it detects that the battery level is running low and does not guarantee proper operation.

Leds

Thermostat



Blue to indicate WiFi status

- Blinks fast when you do not have WiFi configured.
- Turn on and off slowly when you are waiting to receive WiFi settings.
- Off when the connection to the WiFi is correct.

Link box

(hidden under the cover)

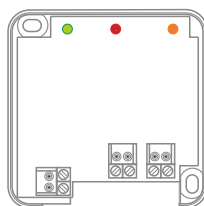

Green when powered at 230V ~



Red when the relay is activated



Orange has no communication with the thermostat (they are far away)

WiFi reset button

Hole on the right side of the thermostat

Clear Wi-Fi settings on the device

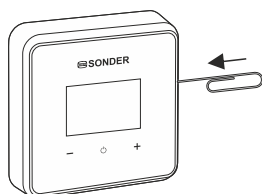

- Press 10 seconds
- Disconnect from power
- Wait 10 seconds
- Connect to the power

It also has a programming reset, within the App in the configuration screen. It will clear all settings, returning them to the factory settings (page 19)

Aplicación Sonder Home

Main screen App



Screen that shows you all the devices linked in the application.

- It allows to have several devices in the same house (thermostats by zones).
- Allows you to configure several devices in several houses (second residence, tourist apartments, ...). You will have to configure on each device the WiFi you will use.
- It allows to be installed in several mobiles (configuring in Log In the same username and password) so several people can access to control the same thermostat.
- From the menu you can access the configuration / erase screen of devices (page 9).



... Device with WiFi connection

... Device without WiFi connection

Home

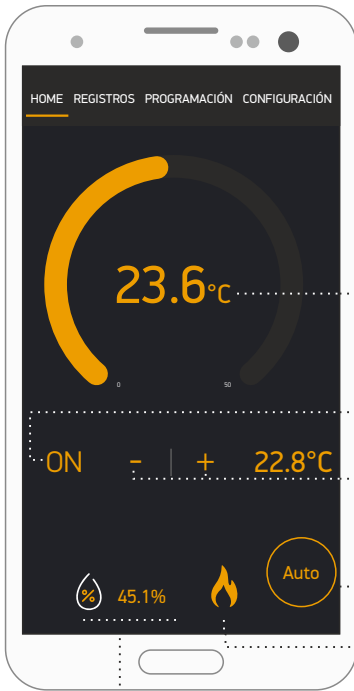

Main display for thermostat

Room temperature

ON / OFF thermostat button

Desired temperature (select setpoint - / + factory at 20°C)

Manual / Automatic Mode (Programmed)(factory set to manual mode)

Regulation mode Heating  / Cooling  (factory set on heating)

Relative humidity in the environment

Registros (Logs)

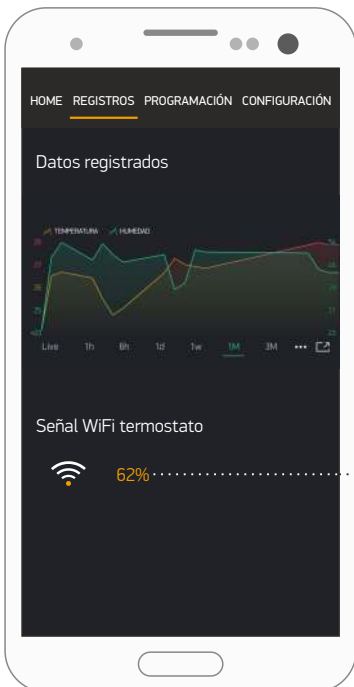

Graph with recorded temperature and humidity readings

- It can show temperature, humidity or both at the same time.
- Pressing on humidity or hidden temperature / shows the values
- Clicking on the period shows the graph for that period
- Pressing ... lets you export a CSV format file or delete data
- Pressing  shows you the record in full screen

WiFi signal strength received by the thermostat

Programación (Programming)



Program the operation of heating and cooling with total freedom, changes are configured where time, temperature and applicable days are indicated. You can memorize up to 8 changes.

It can also work in manual mode, indicating only the temperature.



Set the regulation mode and program it

Clicking on the icon choose the regulation mode

Heating  or Cooling 

Change, has 8 changes for heating and 8 for cooling

Pressing icon activates / deactivates that period without deleting it

Desired temperature (setpoint)

Clicking on the time sets the time of the change and the days to make it. If no day is selected, the program considers that the change is made for every day.

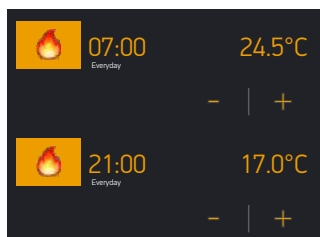

Programming example with two changes configured.

The heating would turn on at **07:00** in the morning and maintain the temperature of **24.5°C** all day, until the next change that would be the second at **21:00**, and would regulate about **17.0°C** all night, until the next change that would be the first change again at **07:00** in the morning. As the changes are set for every day, I would have all week scheduled.

In future versions you will also have the intelligent GeoFence (geolocation) function that adapts the programming to your life rhythm, detecting its location.

If we have the GeoFence function activated, when it detects that we enter the distance radius assigned to home, it activates the regulation in the mode defined in the App, Manual or Automatic (with time programming).

When it detects that we leave the radio assigned to home, it passes the value of the temperature setpoint to that defined in the GeoFence parameter of the configuration menu.

Configuración (Configuration)

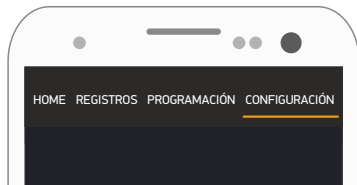

Display to adjust thermostat operation



Protección de la bomba recirculadora (Recirculation pump protection)

The recirculation pump is activated for 1 minute every 24 hours avoiding blockage during long periods of inactivity.

Scale: Activated ... Deactivated **From factory:** OFF



Calibración lectura sensor interno (Internal sensor reading calibration)

Adjusts the temperature displayed on the screen.

Scale: -10.0°C ... 10.0°C **From factory:** 0.0°C



Protección antihielo (Frost protection)

Prevents the ambient temperature from falling below the defined value to protect against damage to the installation by freezing the pipes.

Scale: 4.0 ... 9.0°C **From factory:** 5.0°C



Diferencial de temperatura de activación (Activation temperature differential)

The temperature difference you need between the ambient and the desired (setpoint) to start the accumulator. Example: The setpoint is 22°C, it will stop boiler when it reaches 22°C and turn on again when it reaches 21.7°C.

Scale: 0.1°C ... 3.0°C **From factory:** 0.3°C



Límite humedad máxima en refrigeración (Maximum humidity limit in refrigeration)

Limita la humedad cuando regula en refrigeración para evitar la condensación de agua en el suelo. Cuando llega al valor configurado, detiene la refrigeración para que no siga subiendo el % de humedad y condense.

Scale: 50% ... 100% **From factory:** 100% (disabled)

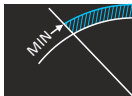

Límite temperatura mínima para la consigna (Minimum temperature limit for the setpoint)

Limit value at which the desired temperature can be lowered. Ideal for public places and tourist apartments.

Scale: 5.0°C ... 35.0°C

From factory: 5.0°C

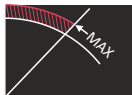

Límite temperatura máxima para la consigna (Maximum temperature limit for the setpoint)

Limit value at which the desired temperature can be raised. Ideal for public places and tourist apartments.

Scale: 5.0°C ... 35.0°C

From factory: 35.0°C



Zona horaria (Time Zone)

Sets the time zone in which the thermostat is located.

Scale: UTC -11 ... UTC +11

From factory: UTC +1 (Madrid / Roma)



Cambio hora Verano / Invierno (Summer/Winter time changeover)

The clock adjusts the set time by adding or subtracting 1 hour for summer and winter time changeover.

Scale: Off / Automatic

From factory: Automatic



Teclado del termostato (Thermostat keypad lock)

Cancels the thermostat keypad to limit access, only the temperature can be modified from the App. Ideal for public places and tourist apartments.

Scale: Enabled ... Locked

From factory: Enabled

[Página de ayuda](#)

[Página de ayuda](#) (Help page)

Link to the online manual of the device.



Pulsando borrará todos los cambios realizados en la programación y volverá a valores de fábrica

Restaurar valores de fábrica

Reset de valores y programación (Reset of values and programming)

Deletes all the adjustments made in programming, configuration and setpoint temperature, leaving all the values with the factory settings.

SONDER REGULACIÓN S.A.

Avenida la Llana N° 93

P.I. La Llana 08191 RUBÍ

(Barcelona) - España

Telf.: +34 93 588 42 11

Fax: +34 93 588 49 94

www.sonder.es

info@sonderregulacion.com