

## Emitter

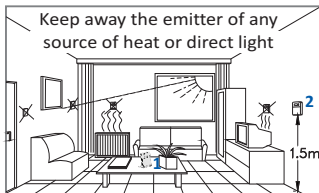

1 Desktop Support (Optional)



2 Wall mounting

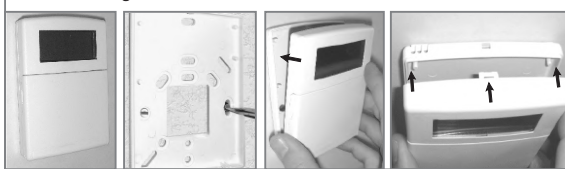

## Receiver

Install away from conductive elements, metal surfaces, electrical cables or excessive heat.

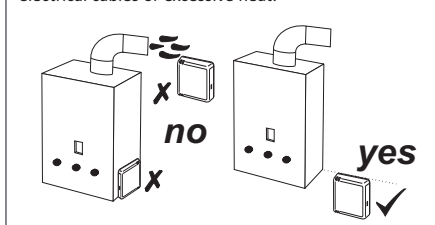

Connections only by qualified personnel

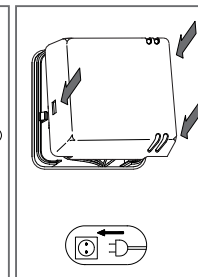
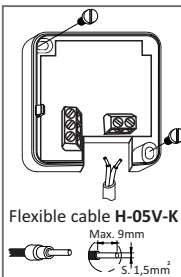
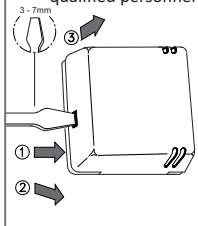

## Batteries replacement - Emitter

Open the battery compartment cover and insert two LR03 AAA 1.5V batteries. Make sure the positive and negative ends are facing the correct direction, as shown picture of side & always introducing them as indicated. The display shows for 2 seconds the program version and then pass to set the internal clock.

**Very Important: Don't use rechargeables batteries**

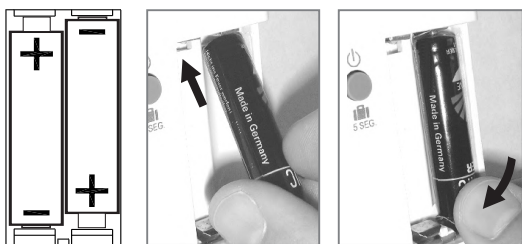

## Technical data

Measures mm:

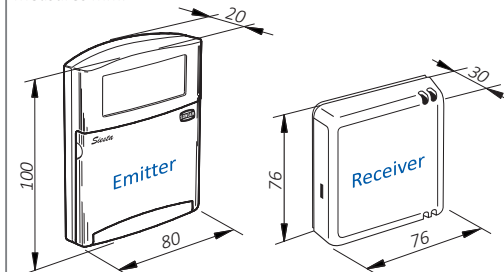

Net weight (with batteries): 124,5 g Net weight: 85,5 g

Receiver Electrical drawing:

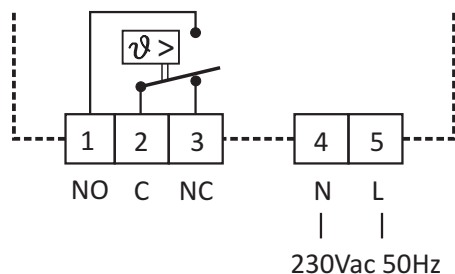

230Vac 50Hz

## First connection & Batteries replacement

### Hour

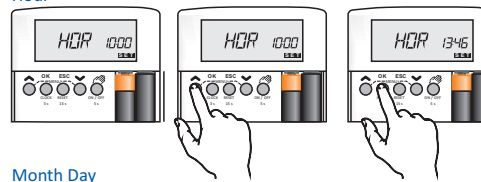

### Week Day

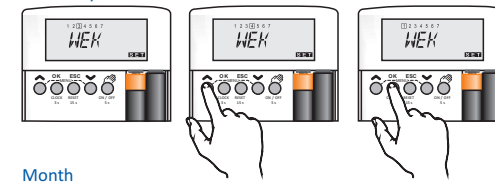

### Month Day

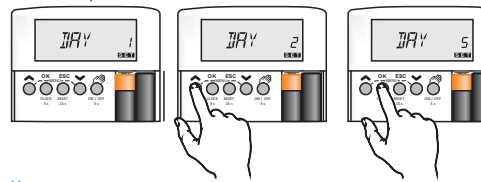

### Month

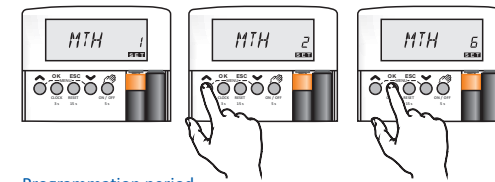

### Year

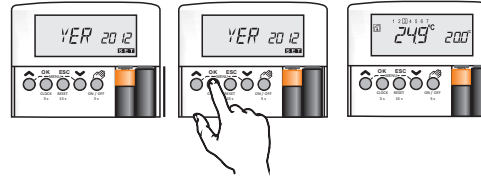

### Programming period

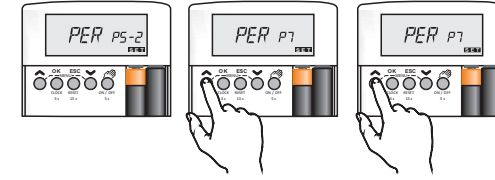

Period P5-2 • from Monday to Friday / Saturday & Sunday

Hour	Temperature	Days	Hour	Temperature	Days
06:00	21°C	Monday...Friday	06:00	21°C	Saturday & Sunday
08:00	17°C	Monday...Friday	08:00	19°C	Saturday & Sunday
12:00	21°C	Monday...Friday	12:00	19°C	Saturday & Sunday
15:00	17°C	Monday...Friday	15:00	19°C	Saturday & Sunday
18:00	21°C	Monday...Friday	18:00	21°C	Saturday & Sunday
22:00	17°C	Monday...Friday	23:00	15°C	Saturday & Sunday

Period P7 • the same for every day

Hour	Temperature	Days
06:00	21°C	Monday...Sunday
08:00	17°C	Monday...Sunday
12:00	21°C	Monday...Sunday
15:00	17°C	Monday...Sunday
18:00	21°C	Monday...Sunday
22:00	15°C	Monday...Sunday

## Regulation in manual mode

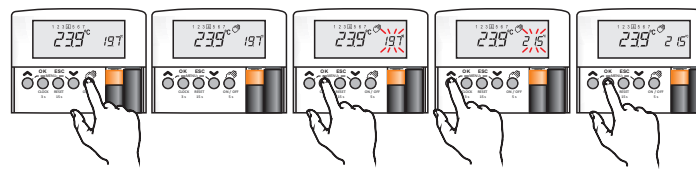

## Data shown on the display

Setpoint Temperature Current time

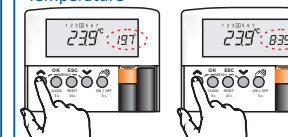

Download the advanced manual from technical web [www.sonder-regulacion.com](http://www.sonder-regulacion.com) (programming step by step, factory settings and how to change them) Direct Link: [http://www.sonder-regulacion.com/manuales/Manual\\_Siesta-CRXE\\_RF\\_Avanzado\\_Ingles.pdf](http://www.sonder-regulacion.com/manuales/Manual_Siesta-CRXE_RF_Avanzado_Ingles.pdf)

## Guarantee conditions

This appliance has a three-years guarantee limited to replacement of defective parts. Transport not included.

We will not accept any responsibility for damage caused to the appliance by poor handling.

The guarantee does not include:

- Appliances with a damaged, effaced or altered series number.
- Appliances which have not been connected or used following the instructions that accompany it.
- Appliances which have been altered without the prior consent of the manufacturer.
- Appliances damaged by blows or liquid spills or gaseous emissions.

### VERY IMPORTANT:

This appliance should be mounted on a universal embedded box.

Device designed for a clean pollution situation.

This control is not a safety device and should not be used as such, is the responsibility to incorporate appropriate protection for each type of facility (homologated) installer.

Independent control device mounting, and connection via fixed pipeline.

We reserve the right of modify without prior notice.

**Sonder Regulación, S.A.**

Avda. La Llana, 93

08191 RUBÍ

(Barcelona) Spain

[www.sonder.es](http://www.sonder.es)



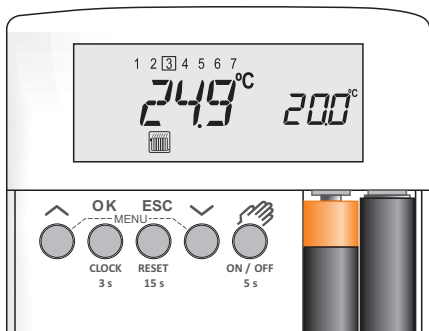

### Example with Period P5-2

Change	Hour	Temperature	Days
1	7:00	22°C	Monday to Friday
2	8:30	16°C	Monday to Friday
3	17:00	22°C	Monday to Friday
4	22:00	OFF	Monday to Friday
5	---	---	
6	---	---	

Change	Hour	Temperature	Days
1	8:30	22°C	Saturday & Sunday
2	10:00	19°C	Saturday & Sunday
3	13:00	22°C	Saturday & Sunday
4	17:00	19°C	Saturday & Sunday
5	19:00	23°C	Saturday & Sunday
6	23:00	15°C	Saturday & Sunday

These 6 changes are preconfigured with default values that can be adjusted to the temperature and time required (See manual advanced in web) changes that do not need to program should be disabled, leaving the clock "-:--" (this setting is between **23:59** and **00:00** as shown in the example graph Steps, in **Change 5**).

### From Monday to Friday

For this example we use only 4 Changes, this implies that Changes 5 and 6 have to be canceled leaving the clock as indicated, otherwise the control works how they leave the factory preset.

At **7:00** am the heat will come on until you reach the house at **22°C**, **Change 1** and continue until **8:30**, after that time will keep the house at **16°C**, **Change 2**. At **17:00** that receives the **Change 3** passes to heat the house up to **22°C** and hold until **22:00** that happens to have the temperature in **OFF** period that does not regulate temperature, only keeps antifreeze, **Change 4**, until the next Change, already again the **Change 1** at **7:00** on Monday.

### Saturday & Sunday

At **8:30** am the heat will come on until you reach the house at **22°C**, **Change 1** and continue until **10:00**, after this time will keep the house at **19°C**, **Change 2**, until **13:00** that receives the **Change 3** and passes to heat the house up to **22°C** and hold until **17:00**, which receives the **Change 4** leaving the temperature to **19°C**. At **19:00** receives the **Change 5** happens to warm to **23°C** until **23:00** maintain **15°C**, **Change 6** to the following order which is **8:30** am on Sunday, **Change 1**, and start again.

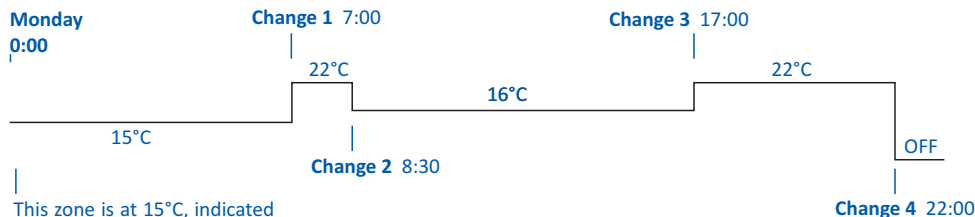

### Steps

#### Change 1 - Monday...Friday

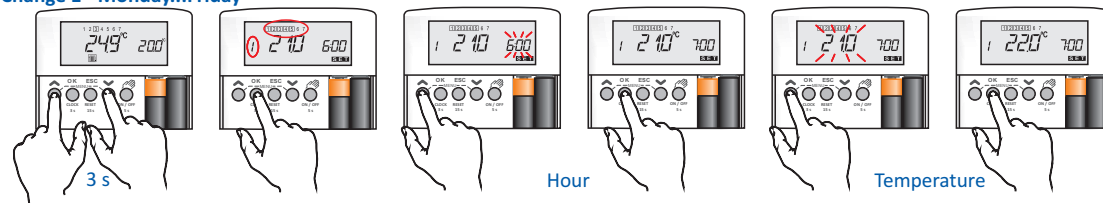

#### Change 2 & 3 - Same procedure

#### Change 4

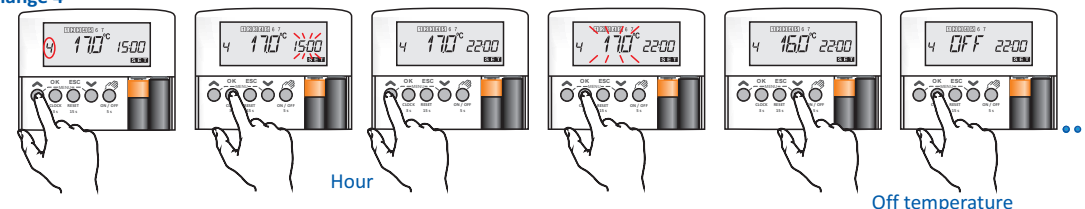

#### Change 5

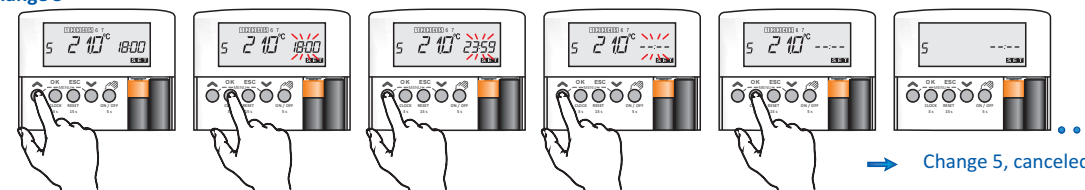

#### Change 6 - Same procedure

#### Change 1 - Saturday & Sunday

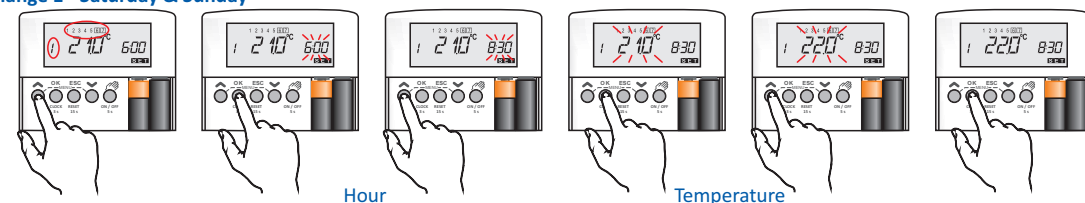

#### Change 2

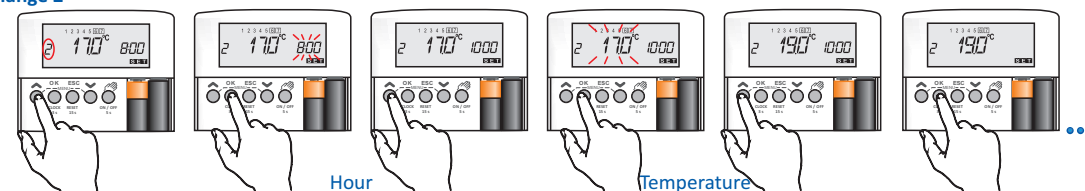

**Changes 3, 4, 5 & 6 - Same procedure.** Now the thermostat is programmed, press ESC to exit.



Family

# *Siesta*-CRX

## Instructions Manual

Model *Siesta* - CRXE RF

Chronothermostat for Heating via Radio  
Generation CorteX



*New Programming*  
*New Display*  
*New Heart*



## INDEX

- 2** Description
- 3** Technical data
- 3** Location
- 4** Installation
- 4** Batteries replacement
- 5** First connection
- 6** Configuration for Clock & Temperature units
- 7** Display information
- 9** Data shown on the display
- 9** Regulation in manual mode
- 9** Programming in automatic mode
- 10** Reset
- 11** Coding between emitter and receiver
- 12** Guarantee condition

## Description

It is a digital thermostat heating for residential use batteries, and radio communication (wireless) in which there are 2 different programs, through the system of periods (blocks) of days:

**P5-2:** in which has 6 changes (time and temperature), Monday through Friday and 6 more changes for the weekend.

**P-7:** The six changes are made equal to every day, Monday to Sunday.

Factory programming are preset, you can change these settings with the time and desired temperature. It can also operate in manual mode, setting only the temperature control.

Note: Emitter and receiver are encoded factory, if you need to recode see how to do it on page 11.

### Emitter

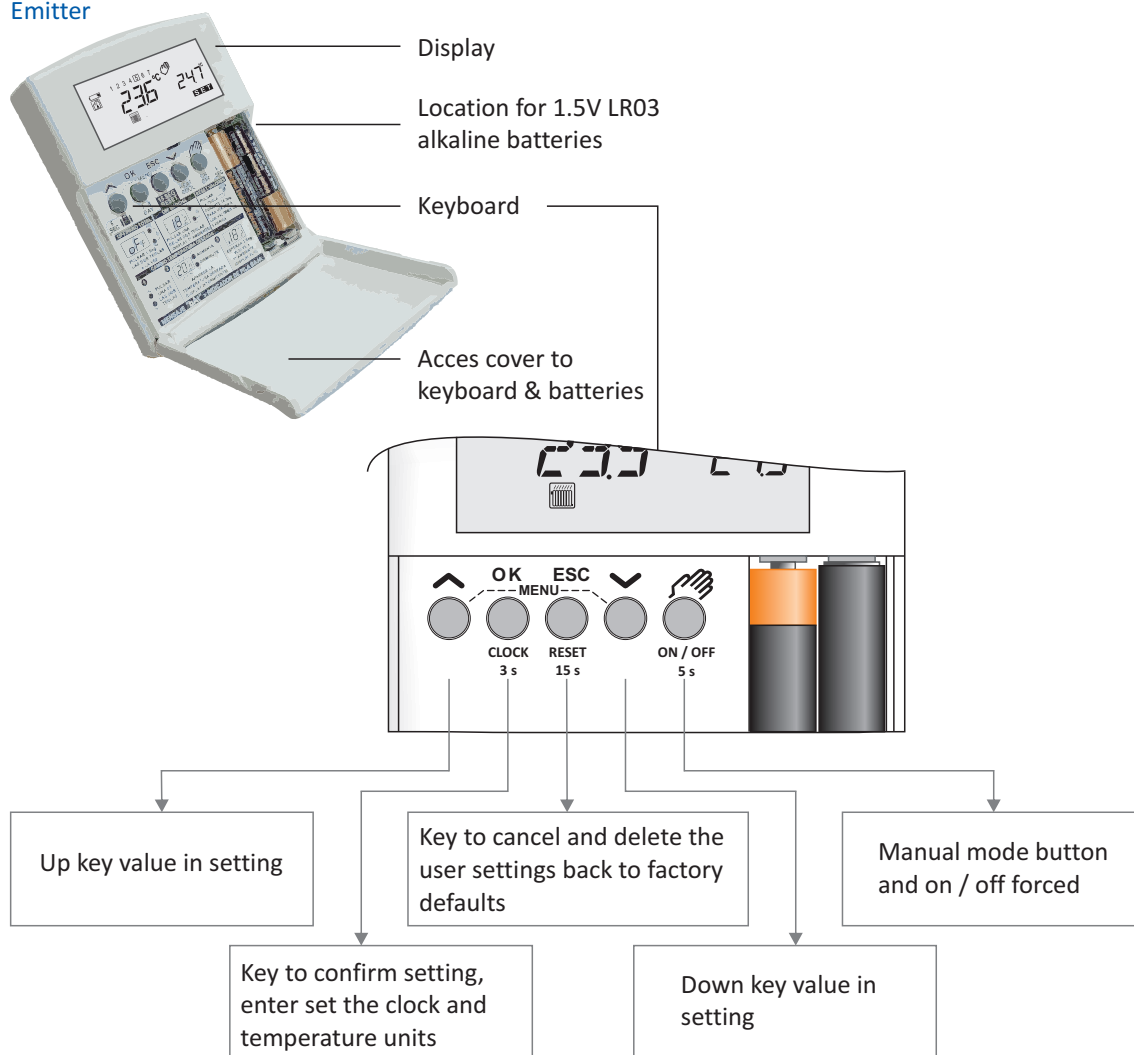

### Receiver

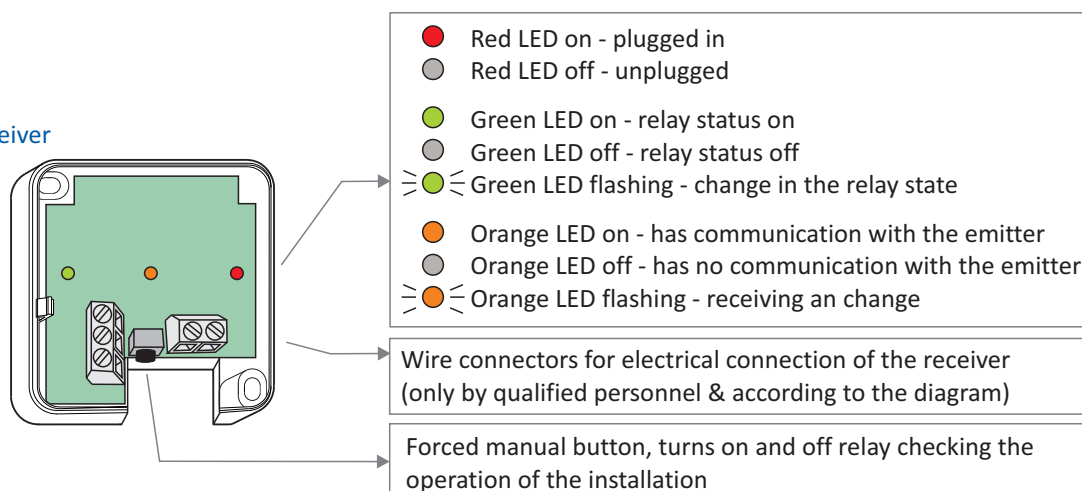

## Technical data

### Emitter measures mm

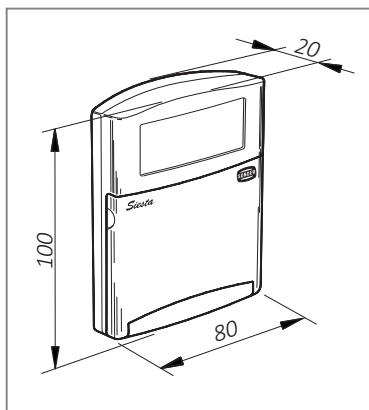

### Receiver measures mm

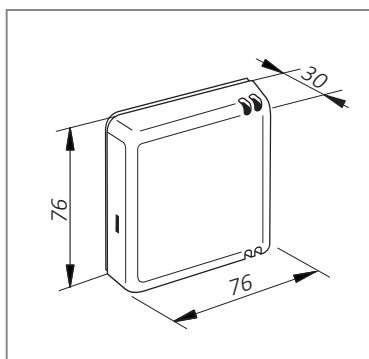

### Specifications

#### Emitter

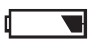
Regulation scale:..... **from 5 to 35°C**  
 1,5V Alkaline battery (2 pcs):..... **LR03 (AAA)**  
 Low battery indicator:.....   
 Battery duration:..... **1,5 year, aprox**  
 Net weight (with batteries):..... **124,5 g**

#### Receiver

Power supply:..... **230Vac 50Hz**  
 Breakage power (contacts):..... **16(8)A 250Vac**  
 Maximum cable to connect:..... **1,5mm<sup>2</sup>**  
 Type wiring:..... **H-05V-K**  
 Net weight:..... **85,5 g**

#### Both

Transmission frequency:.....**868,3 MHz**  
 Approx. Max. distance Emitter-receiver:..... **90 m in free field**  
 Ambient temperature:..... **Tmin. 0°C, Tmax. 40°C**  
 Storage temperature:..... **maximum 50°C**  
 Operating % R.H.:..... **from 20 to 85%**  
 Degree protection:..... **IP20**  
 Degree pollution:..... **2**  
 Software:..... **Class A**  
 Action type according EN 60730:..... **1.B**  
 Homologated:..... **CE**  
 Gross weight:..... **231 g**

### Electrical drawing

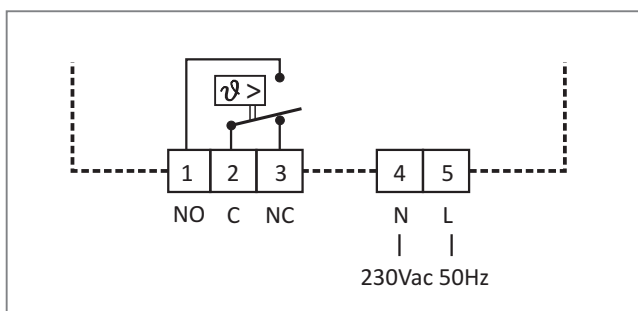

## Location

**Emitter** - Keep away the emitter of any source of heat or direct light.

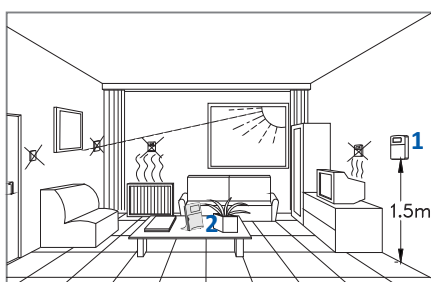

**Receiver** - Install away from conductive elements, metal surfaces, electrical cables or excessive heat.

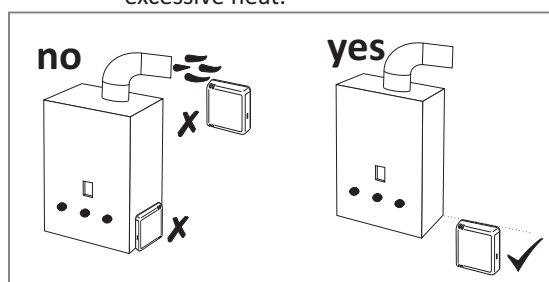

## Installation

### Receiver

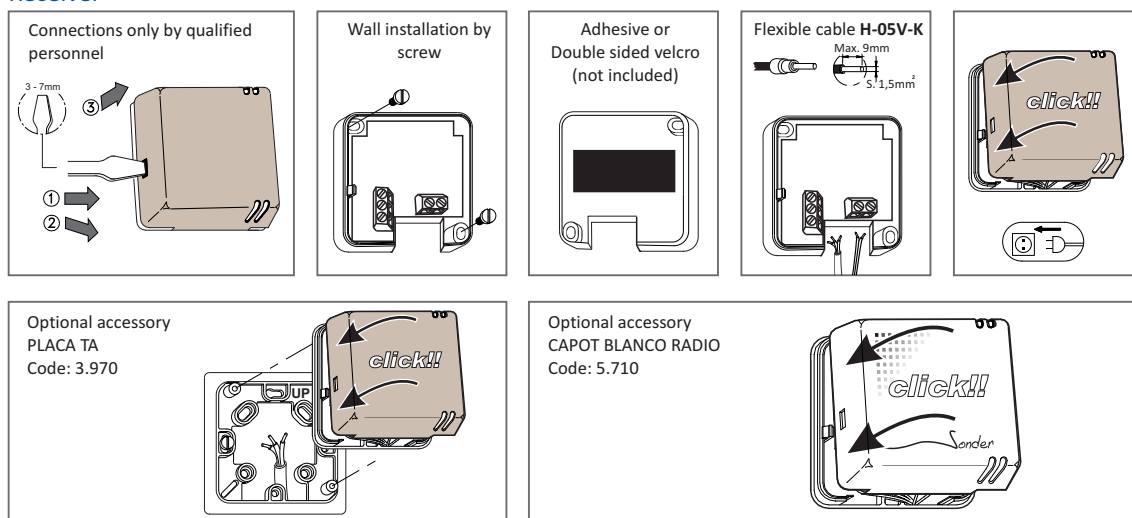

### Emitter

#### 1 - Wall installation

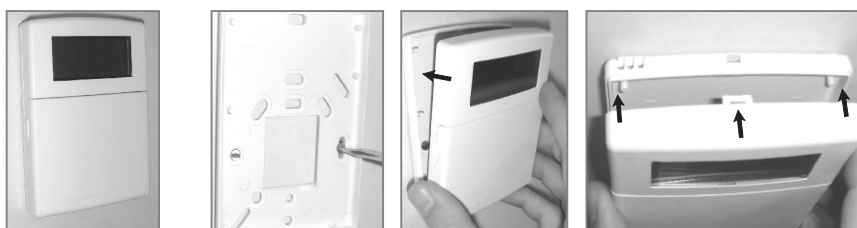

#### 2 - Support to put over table

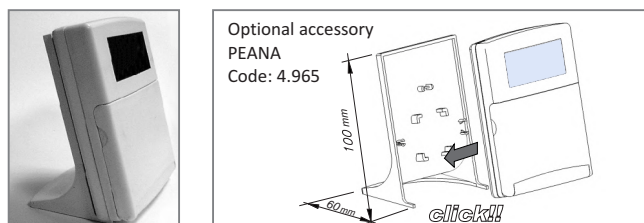

## Batteries replacement

Open the battery compartment cover and insert two LR03 AAA 1.5V batteries. Make sure the positive and negative ends are facing the correct direction, as shown picture of side & always introducing them as indicated. The display shows for 2 seconds the program version and then pass to set the internal clock.

**Very Important: Don't use rechargeables batteries**

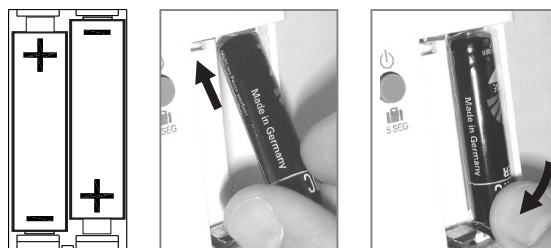



## First connection

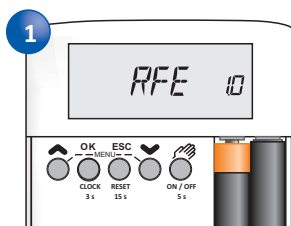

Version

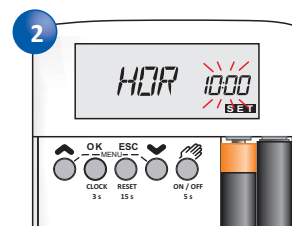

2 s

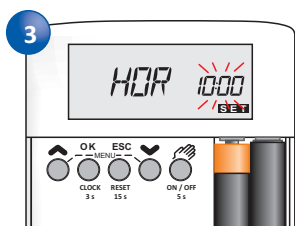

Hour

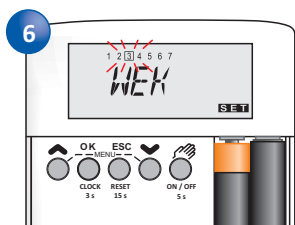
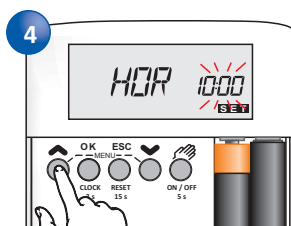

Week day

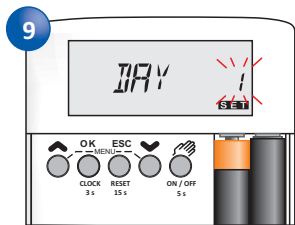
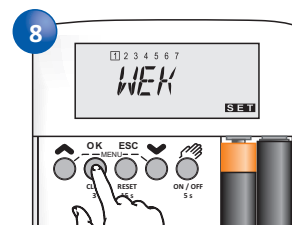
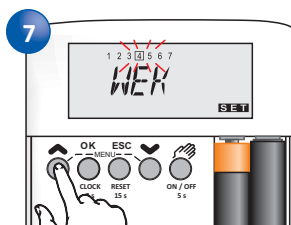

Month day

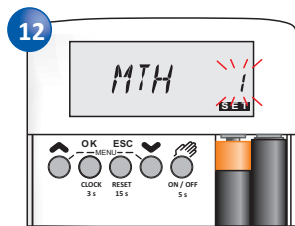
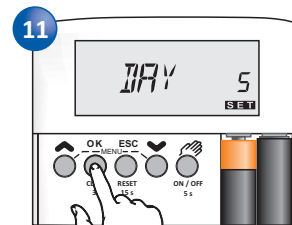
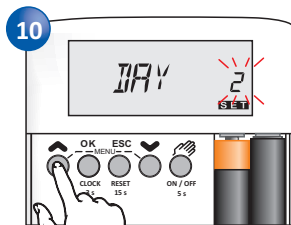

Month

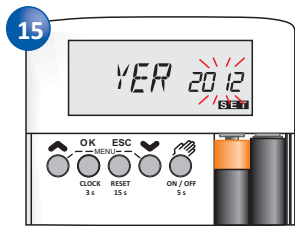
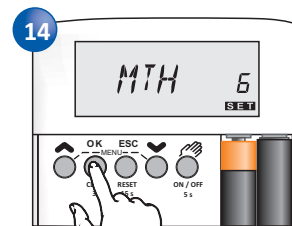
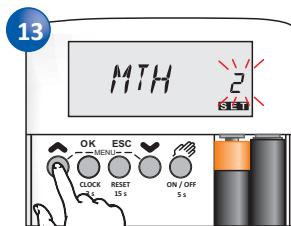

Year

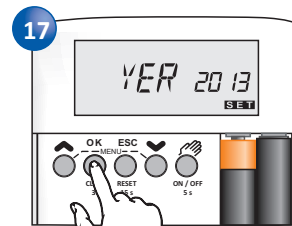
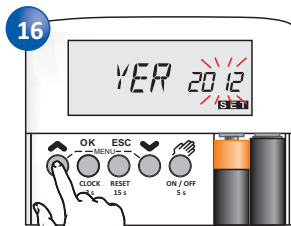



## Fisrt connection

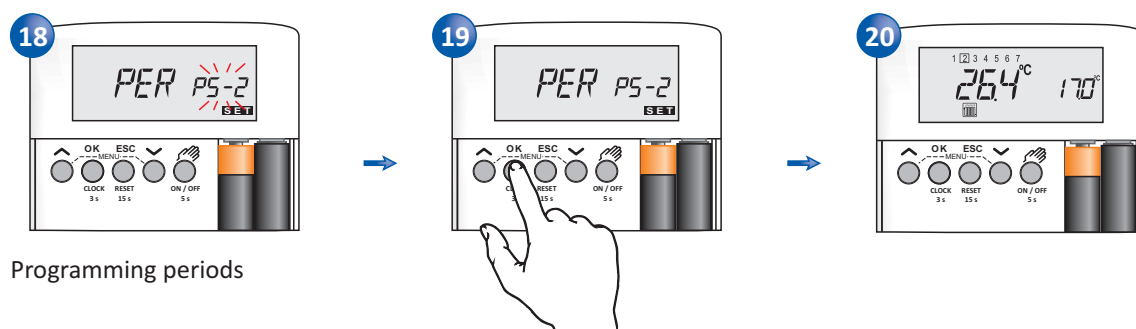

It is within P5-2 period if accepted with OK finished programming.

If you select P7 period, because it is suited best for your needs, and accept with OK, you have finished programming.

## Configuration for Clock & Temperature units

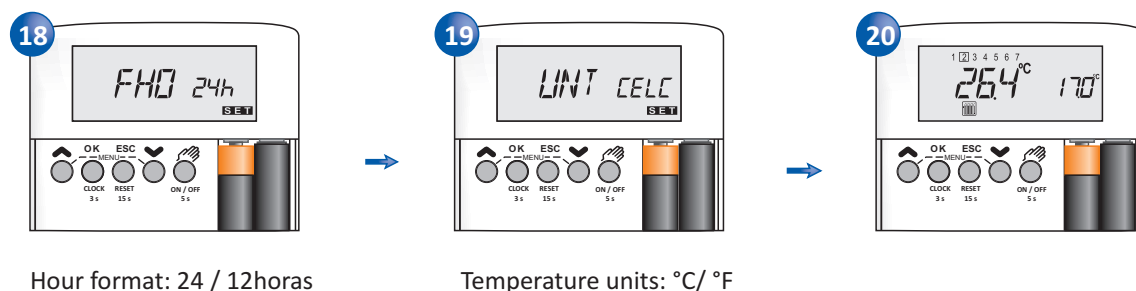
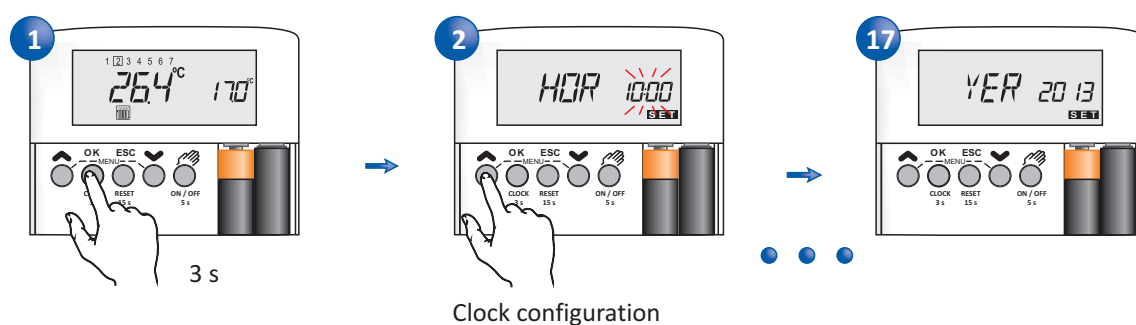

## Display information

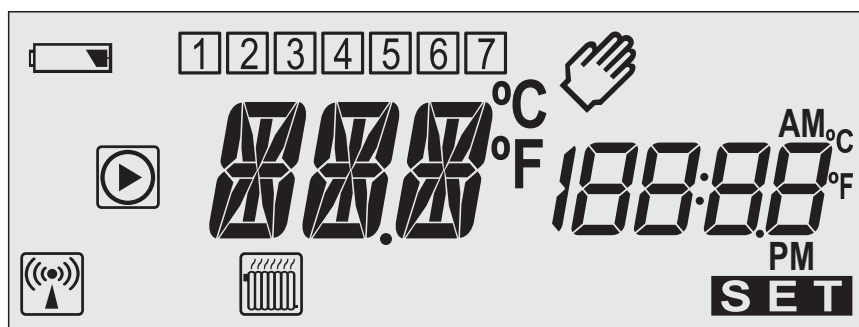

### Manual mode

Shown on the display when the control is in manual mode. Only has to adjust the temperature by the arrows.

Pressing the key  moves in and out of manual mode.

ON / OFF  
5 s

### Automatic mode

Programming changes (temperature and time), 6 changes by day, the control automatically regulates heating.

You can set 6 changes Monday through Friday and 6 changes the weekend, or 6 changes everyday ... just for your needs.



### Manual off

OFF

The device no control the temperature, only remains the Frost protection function and pump protection.



### Regulation in heating

Shown on the display with regulation in heating mode: Relay switched on when the temperature is below the setpoint minus differential & relay switched off when arrives to setpoint.



### Activated relay

Shown on display when boiler or pump is activated.

SET

### Programmation

Shown on display when you are within programming.



### Batteries

Shown on the display when the batteries status is low and should be changed.

### Days

1 2 3 4 5 6 7

The square will mark the current day and also the day on which the change is executable.

## Display information

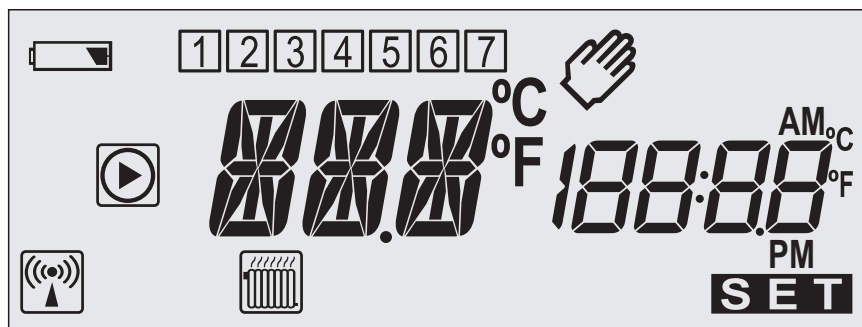

### Frost protection

The control does not allow the temperature drops below the limit temperature that supports the installation just before the water pipes from freezing. It is a fixed setting and is from the factory at 5°C.

### Reset



Pressing by 15 seconds the key  deletes the custom settings of the parameters and return to the factory settings.

### Digits



The displays shows with the big digits for the reading for ambient temperature and in smaller digits the temperature setpoint or current time.



### Coding Emitter-receiver

Shown on display when the control is in the process of coding between sender and receiver (see page 14) and disappears when the process is complete.

## Data shown on the display

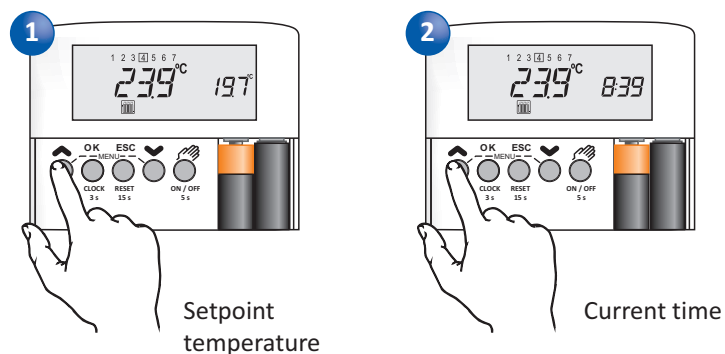

## Regulation in manual mode

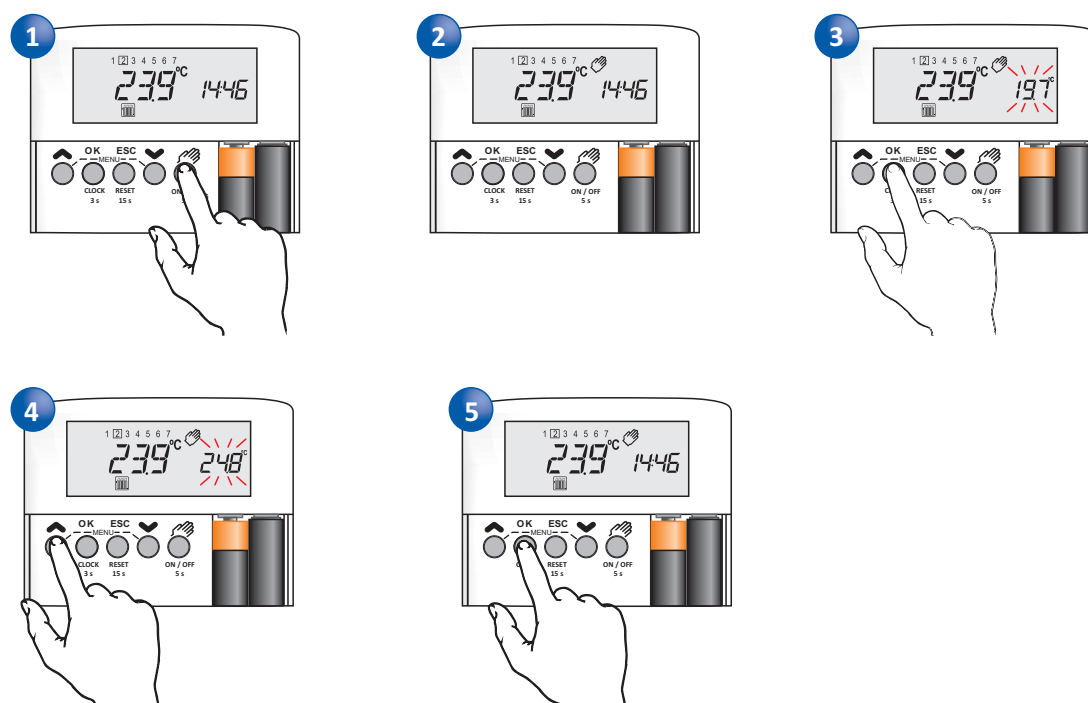

## Programming in automatic mode

Depending on the setting in the first connection, the thermostat will work with the factory default values for that period (P5-2: 6 changes Monday through Friday and 6 changes for Saturday and Sunday / P7: 6 changes Monday to Sunday).

To switch from one programming period to another is to remove the battery, wait 2 seconds and restart the thermostat. If you switch from one mode to another change custom settings are deleted and become the factory default.

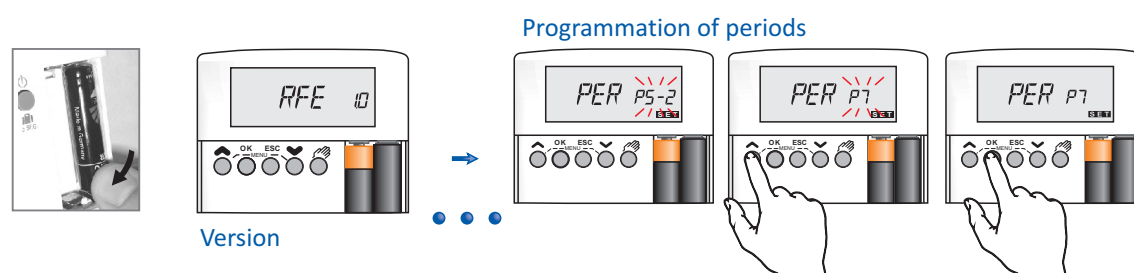

## Factory defaults for automatic mode

Period P5-2 • from Monday to Friday / Saturday & Sunday

Hour	Temperature	Days	Hour	Temperature	Days
06:00	21°C	Monday...Friday	06:00	21°C	Saturday & Sunday
08:00	17°C	Monday...Friday	08:00	19°C	Saturday & Sunday
12:00	21°C	Monday...Friday	12:00	19°C	Saturday & Sunday
15:00	17°C	Monday...Friday	15:00	19°C	Saturday & Sunday
18:00	21°C	Monday...Friday	18:00	21°C	Saturday & Sunday
22:00	17°C	Monday...Friday	23:00	15°C	Saturday & Sunday

Period P7 • The same for every day

Hour	Temperature	Days
06:00	21°C	Monday...Saturday
08:00	17°C	Monday...Saturday
12:00	21°C	Monday...Saturday
15:00	17°C	Monday...Saturday
18:00	21°C	Monday...Saturday
22:00	15°C	Monday...Saturday

## Customizing the settings for automatic mode

P5-2

Monday to Friday 1 2 3 4 5 6 7

Nr. change	Hour	Temperature
1	09:03	23°C
2		
3		
4		
5		
6		

Saturday & Sunday 1 2 3 4 5 6 7

Nr. change	Hour	Temperature
1		
2		
3		
4		
5		
6		

P7

Same for every day 1 2 3 4 5 6 7

Nr. change	Hour	Temperature
1		
2		
3		
4		
5		
6		

### Programming for change: 1

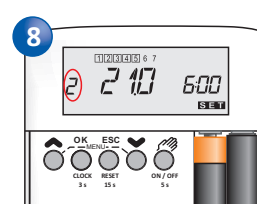
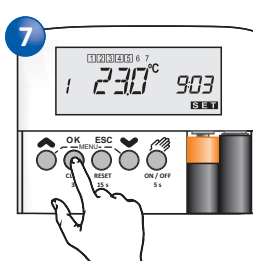
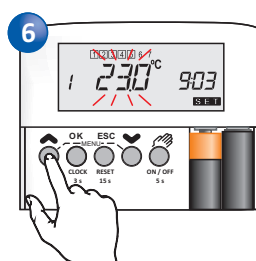
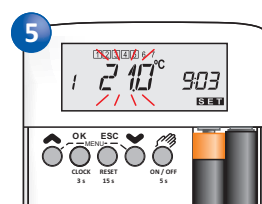
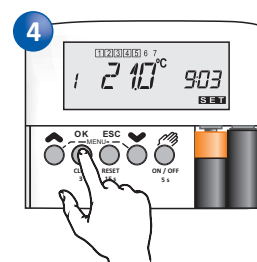
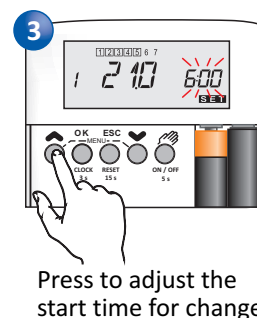
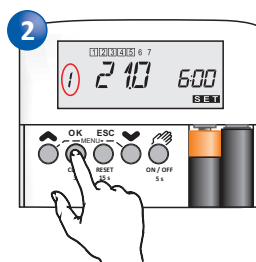
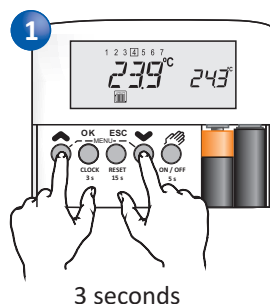

### Reset

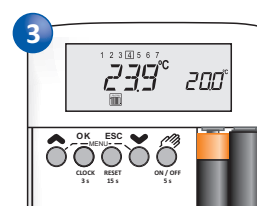
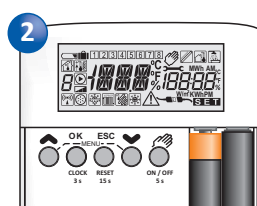
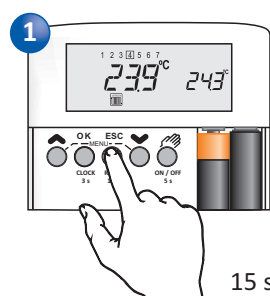

## Coding between emitter and receiver

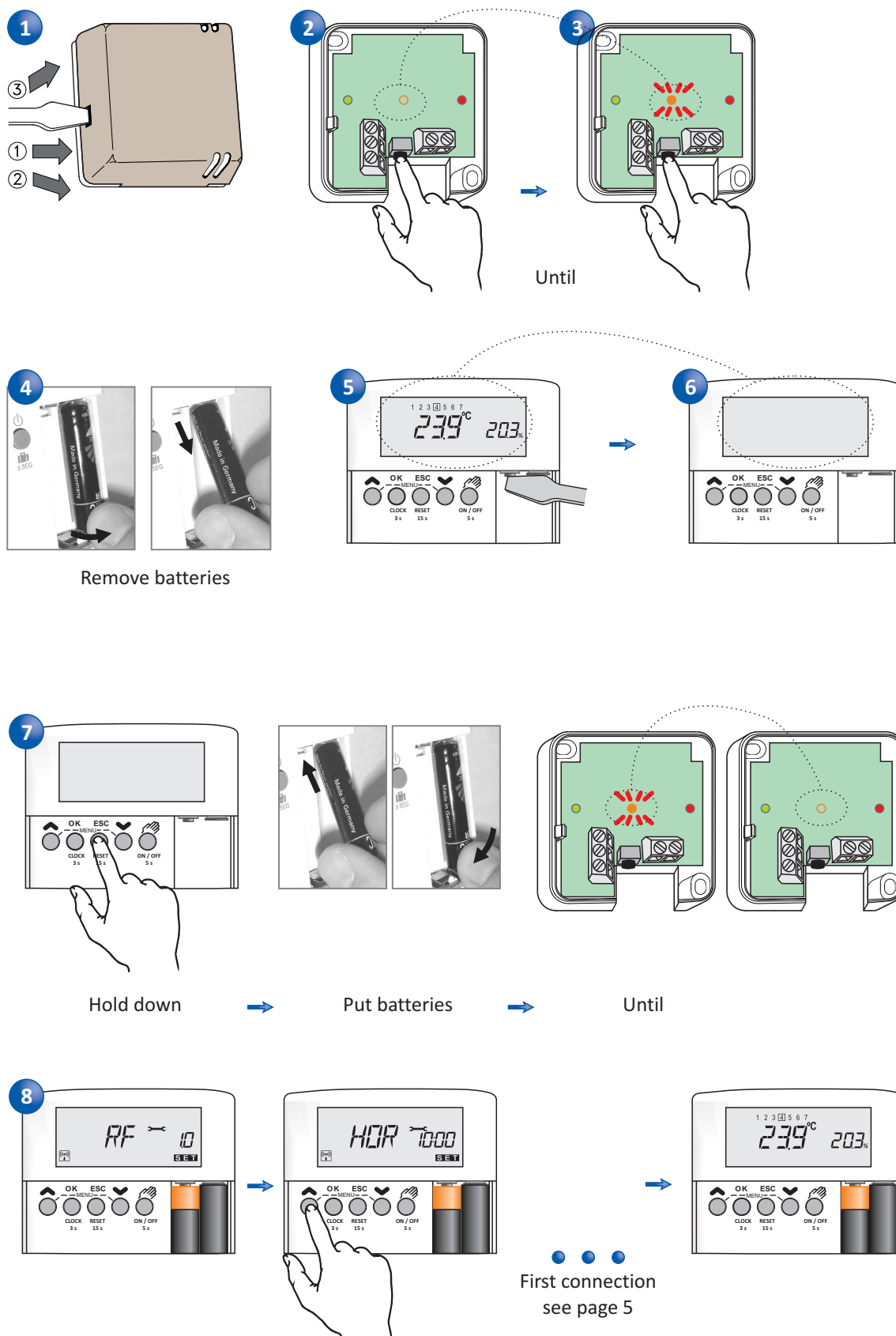

## Guarantee conditions

*Note: Translation is informative, the only legally binding document is the written version of it in Spanish.*

*First of all thank you for the purchase and trust placed in the team. We hope that the thermostat Siesta meets the needs of your installation.*

- Before installing the thermostat make sure that environmental conditions are suitable, temperature, humidity, pollution and greenhouse gas emissions, and that any of these factors may affect the efficient operation
- The device is an independent control device for surface mounting on a universal embedded box, and type 2 dry environment pollution.
- For any work, either as installation or repair, the regulator must be disconnected from the power supply.
- Electrical connections may only be indicated in this manual and on the sticker on the back of the cap connections.
- This controller is not a safety device or can be used as such, is responsible incorporate appropriate protection for each type of facility (homologated) by the installer.
- Installation, electrical connection, commissioning and maintenance must be performed only by qualified personnel.
- If visualize possible defects that could cause damage or malfunction in the system, do not connect the appliance.
- Forbidden the total or partial reproduction of this document by any means without prior written authorization of Sonder Regulación S.A.
- The graphics and information in this manual are indicative only and may include technical inaccuracies or typographical errors.
- Sonder Regulación S.A. reserves the right to make changes to the product, technical data, or instructions for assembly and use without notice.

This device has 3 year warranty, it is limited to replacement of the defective part and will be delivered in the same material reception conditions, packaging, batteries, instructions or any other accessory that includes this product will not be replaced and not be noted in the packing slip.

We decline any responsibility for damage caused to the appliance by bad handling, failure to follow instructions contained in this manual or technical ignorance of the needs of the installation.

For repairs under warranty must present the documentation that accredits purchase of the device within the validity period of this warranty and as accurate a description as possible of the defect or anomalous behavior of the product according to the user.

If the repair is out of warranty, it will inform the user of the viability and cost of it. The valuation of our technical department may be an additional cost to the user.

Are out of guarantee:

- Devices with serial number deteriorated, deleted or modified.
- Devices whose connection or use have not been implemented in accordance with the attached to the appliance.
- Devices modified without prior agreement with the manufacturer.
- Devices damaged by blows or liquid or gaseous emanations.
- Devices with natural wear or improper use of equipment.
- **The costs resulting from the sending or receipt of material.**
- The demands for damages on account of loss of profits, compensation for use, & consequential damages. Provided that these damages are not mandatory liability under the law.



Designed and manufactured by Sonder in Rubí as:  
UNE-EN 60730-1 + A1:2005 + A12:2004 + A13:2005  
UNE-EN 60730-2-1: 1998 + A11:2005

Sonder Online Shop [www.sonder.es](http://www.sonder.es)  
Technical Information [www.sonder-regulacion.com](http://www.sonder-regulacion.com)

