

QUAD - TA24 Cód.: 29.030
QUAD - TA230 Cód.: 29.026
QUAD - TA230 RF Cód.: 29.040

Installation instructions

Thermostat Digital

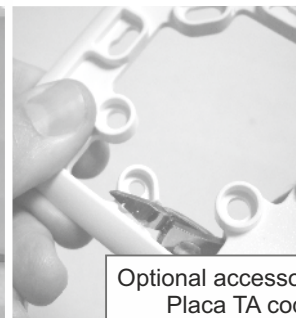

Optional accessory installation
Placa TA code: 3.970

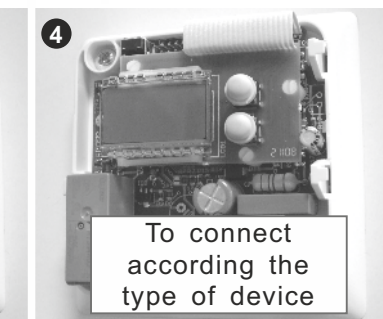
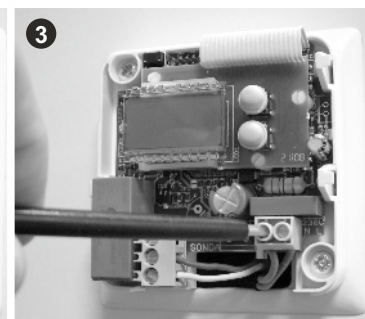
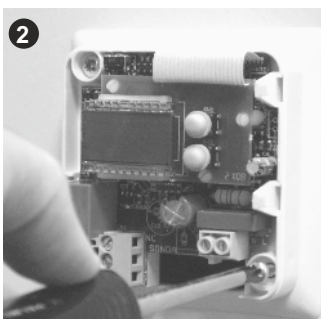

To connect
according to the
type of device

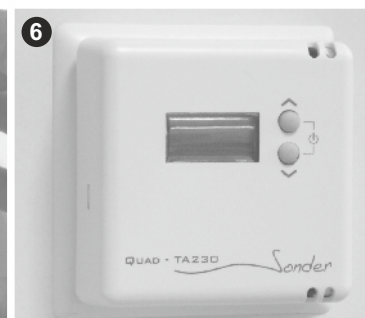
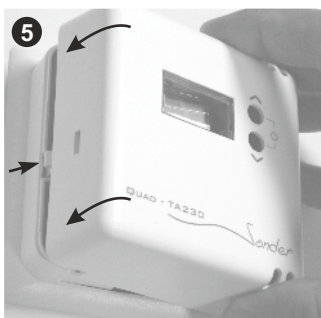

• CHANGING CONTROL TYPE:
HEATING / COOLING

• RESET

UPPER
ORIFICE

GUARANTEE CONDITIONS

This appliance has a three-years guarantee limited to replacement of defective parts.

We will not accept any responsibility for damage caused to the appliance by poor handling.

The guarantee does not include:

- Appliances with a damaged, effaced or altered series number.

- Appliances which have not been connected or used following the instructions that accompany it.

- Appliances which have been altered without the prior consent of the manufacturer.

- Appliances damaged by blows of liquid spills or gaseous emissions.

For the rest of general conditions visit our web.

Electronic Thermostat

VERY IMPORTANT!

It is installer's responsibility to fit electrical protection suitable for the installation (STANDARDIZED).

This appliance should be mounted on a universal recessed box.

Device designed for use in non-polluted environments.

Independently mounted control device for surface mounting and connection to fixed wiring.

We reserve the right to make modifications without prior notice.

QUAD - TA230/24/RF

Sonder Regulación, S.A.

Avda. La Llana, 93

08191 RUBÍ

(Barcelona) Spain

www.sonder.es



Cod:5792 ING2 ENE21

USE instructions



QUAD - TA24 Cód.: 29.030
QUAD - TA230 Cód.: 29.026
QUAD - TA230 RF Cód.: 29.040

FACTORY PARAMETERS IN HEATING MODE

SELECTION OF THE REGULATION MODE: THERMOSTAT WITH TWIN MANUAL SETTING > NORMAL MODE AND ECO MODE

The two regulations modes, NORMAL and ECO, are independent regulation modes and both can be adjusted to temperatures between 5 °C and 35 °C. Depending on the selected values, you can use the setting for NOCTURNAL REDUCTION, e.g. NORMAL Mode at 22 °C and ECO Mode at 18 °C.

If, on the contrary, you programme two values, e.g. NORMAL Mode at 22 °C and ECO Mode at 20 °C, you can have two COMFORT levels.

1 Upon connection the room temperature is displayed (1st temperature)



2 Pressing ∇ changes to 2nd temperature regulation is displayed



3 Pressing ∇ returns regulation to Normal Mode (1st temp.)



CHANGING THE REGULATION TEMPERATURES

1 Set the thermostat to the regulation mode you want to change. NORMAL Mode or ECO Mode.

Pressing ∇ will change the temperature (flashing display)



Pressing ∇ reduces the temperature (flashing display)



Pressing ∇ increases the temperature (flashing display)



Wait 3 seconds and it returns to room temperature (fixed display)



OFF
With the display on Room Temperature (fixed display) Press the two keys at the same time. OFF and room temperature alternate.



ON
Pressing ∇ or ∇ . Returns to room temperature (1st temp. or 2nd temp. ECO)



ENTRY INTO OPTIONAL PARAMETER SETTINGS

1 Pressing ∇ will input the desired temperature (flashing display)

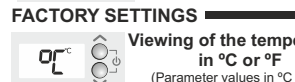

2 Pressing ∇ and ∇ for 10 sec. Both at once



3 Will enter optional parameters

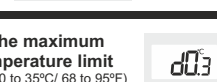

4 Advance to the next parameter Change the value of the parameter

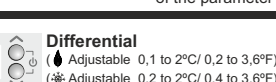

FACTORY SETTINGS

Viewing of the temperature in °C or °F
(Parameter values in °C or °F)

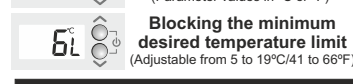

Blocking the maximum desired temperature limit
(Adjustable from 20 to 35°C/ 68 to 95°F)

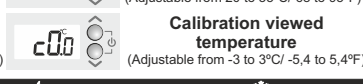

Differential
Adjustable 0,1 to 2°C/ 0,2 to 3,6°F
(Adjustable 0,2 to 2°C/ 0,4 to 3,6°F)



Blocking the minimum desired temperature limit
(Adjustable from 5 to 19°C/41 to 66°F)



Calibration viewed temperature
(Adjustable from -3 to 3°C/ -5,4 to 5,4°F)



Anti-frost function
Adjustable from OFF or 5°C to 18°C 41°F to 64°F



Changing Control Type > HEATING (factory) / COOLING

If you press the key once, you view the current Control type, if you press again, you CHANGE the Control type.

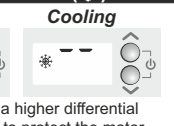
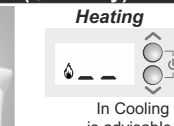

In Cooling a higher differential is advisable to protect the motor.

RESET SETTINGS

Press the key for 10 seconds and the parameters change to the factory settings.



TECHNICAL DATA

Dimension:

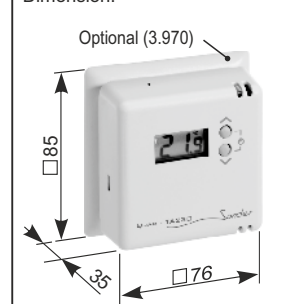

Weight net (gross): 108g (135g)

Schematic:

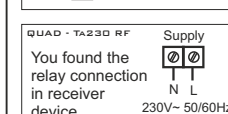
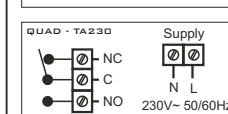
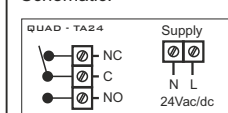

Control scale:.....5° to 35°C.
Ambient temperature:.....Tmin. 0°C, Tmax. 40°.
Storage temperature:.....maximum 50°C.
Breaking power (Volt-free Contacts):.....16(7)A 250V~.
Maximum cable size for connection relay:.....2,5mm².
Power supply QUAD - TA24:.....24Vac/dc.
QUAD - TA230:.....230V~ +10% 50/60Hz.
QUAD - TA230 RF:.....230V~ +10% 50/60Hz.
Maximum cable size for connection supply:.....1,5mm².
Contamination degree:.....2.
Ingress Protection:.....IP20.
Software type A:.....(Action type 1.B).
Assigned pulse voltage:.....2500 V.
QUAD - TA230 RF:
Frequency signal:.....868,3 Mhz.
Max. Distance Emitter - receiver:.....80m m free field.
Repetition emitter-receiver signal:.....every 10 min.