

DESCRIPCIÓN / DESCRIPTION

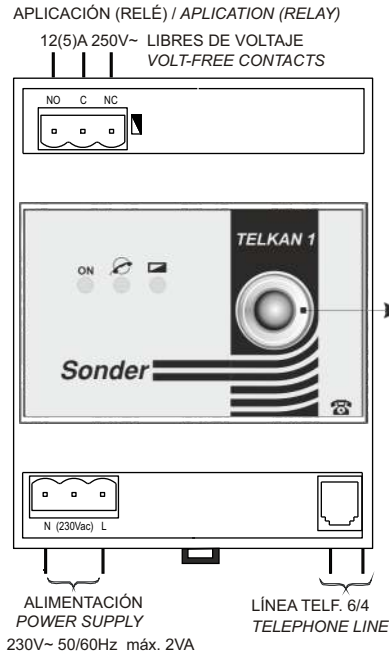

MONTAJE / MONTAGE

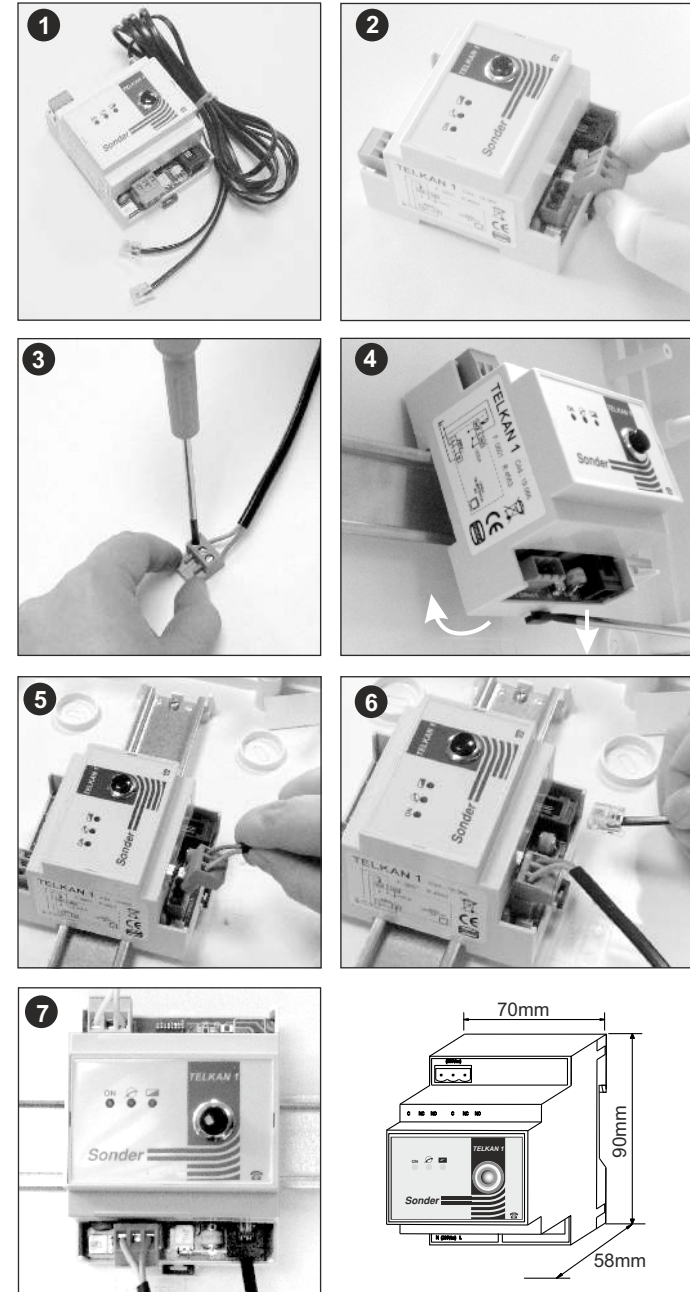

LEDS

- ON Alimentado
Power
- Telkan 1 toma la línea telefónica
Telkan 1 pick up the phone line
- Relé conectado / desconectado
Connected / disconnected relay

Control Telefónico de 1 Canal

1 Relay Phone Control



Sonder Regulación, S.A.
Avda. La Llana, 93
08191 RUBÍ
(Barcelona) Spain
www.sonder-regulacion.com

OPERATING INSTRUCTIONS

ESTABLISHING A CONNECTION

When **TELKAN 1** is installed on a stand-alone telephone line - The device answers after eight ring tones.



When **TELKAN 1** is installed on a telephone line shared with a fax or an answering machine - Call and then hang up after the first ring tone, dial again between 8 seconds and 1 minute later. The device will then respond before the answering machine or fax cuts in.



ENTER THE ACCESS CODE

The device hangs up and asks the caller to "**enter the access code**" (factory setting: 0000). The caller is allowed three attempts to enter the code correctly. If entered incorrectly three times, **TELKAN 1** disconnects the call.

Once **TELKAN 1** says "**the access code is correct**", you can access the functions.

STATUS AND FUNCTIONS

TELKAN 1 indicates relay status with the messages:

"relay connected, press 2 to disconnect the relay"

"relay disconnected, press 1 to connect the relay"

TELKAN 1 has the following functions:

Press	
1	Connects the relay, as requested by TELKAN 1
2	Disconnects the relay as requested by TELKAN 1
#	Enters the language selection menu (to select English, press 1)
0	Enters the menu to change access code (factory setting: 0000)
*	Confirms current settings and TELKAN 1 leaves the telephone line free after signing off

ENDING A CALL

- To end a call it is advisable to press the *) button before hanging up to ensure that **TELKAN 1** leaves the telephone line free.

- Once the call is established, if no commands are given for 15 seconds, **TELKAN 1** disconnects and leaves the telephone line free.

- For security reasons **TELKAN 1** terminates the connection (leaves the line free) five minutes after connection started, even if it is still receiving commands.

TECHNICAL SPECIFICATIONS

- Power supply : 230V~ +10% -15% 50/60Hz max 2VA.

- SPDT relay 12(5)A 250V~ . Volt-free contacts.

- Multi-tone telephone line with voice synthesiser.

- H05VV-F or H05RR-F cable.

- Minimum cable size for connection: Relay → 2.5 mm² / Power → 1 mm².

- Continuous operation: Class A software - automatic action type 1.B - stand-alone device.

- Operating conditions: 0°C to 45°C, 20% to 85% humidity, pollution: clean atmosphere.

- Lightning protection.

CONDITIONS OF GUARANTEE

This device has a 3 year guarantee limited to the replacement of faulty parts.

We cannot accept responsibility if damage or failure is due to misuse of the device. The guarantee does not cover:

- devices with a damaged, erased, or altered serial number;

- devices that have been used or connected in a way other than as described in the accompanying instructions;

- devices that have been modified without prior agreement from the manufacturer;

- devices that have been damaged by gas or water leaks, or as a consequence of an impact.

The person fitting the device is responsible for incorporating adequate electrical protection.

(INSTALLATION MUST BE OFFICIALLY APPROVED).

The manufacturer reserves the right to modify conditions without prior notice.